



Contents

Schedule..... 4

Welcome to the 23rd Annual Summit 6

Welcome from the PNWER President 7

PNWER: A Bi-national Public/Private Partnership..... 8

PNWER 2012-2013 Leadership..... 9

Keynote Speakers 10

Detailed Agenda..... 15

 Sunday, July 14 15

 Monday, July 15..... 15

 Tuesday, July 16..... 16

 Wednesday, July 17..... 21

 Thursday, July 18 27

 Friday, July 19..... 29

Policy Tours 28

Sponsors 37

Hotel Captain Cook Map 47

Dena'ina Convention Center Map..... 48

Marriott & Anchorage Maps 50

Conference Schedule



Sunday July 14th	
11:30am - 6:00pm	Registration - <i>Marriott second floor foyer</i>
12:00pm - 1:00pm	Executive Board Lunch (Invitation Only) - <i>Denali Room, Marriott</i>
1:00pm - 5:00pm	Executive Board Meeting (Open to all participants) - <i>Kenai Room, Marriott</i>
6:00pm - 8:00pm	Opening Reception featuring U.S. Senator Lisa Murkowski , Alaska. Hosted by ExxonMobil - <i>Marriott Ballroom</i>
9:00pm	Hospitality Suite hosted by BP - <i>Crows Nest Suite, 19th Floor, Captain Cook</i>

Monday, July 15th	
7:00am - 5:00pm	Registration - <i>Marriott second floor foyer</i>
7:30am - 9:15am	Opening Breakfast panel “Arctic Challenges and Opportunities,” featuring John Higginbotham , Senior Distinguished Fellow at Carleton University; Hugh Short , CEO of Platinum Advisors; Crawford Patkotak , Chairman, Board of the Arctic Slope Regional Corporation; and Teresa Imm , Vice President of Resource Development for Arctic Slope Regional Corporation. Moderated by Alice Rogoff , Publisher and Owner at Alaska Dispatch Publishing; - <i>Marriott Ballroom</i>
9:30am - 5:30pm	26 Glaciers Cruise Buses depart from the Marriott at 9:30 am; please wear warm layers and comfortable shoes. Please bring the ticket included in your registration packet. Cruise participants will travel directly to the Alyeska Resort after the cruise
6:00pm - 9:00pm	Reception hosted by Shell - <i>Alyeska Resort, Columbia Ballroom, Girdwood</i> . Transportation provided from the Marriott and 26 Glacier Cruise. Buses depart from the Marriott at 5:30 pm

Tuesday, July 16th (All sessions at the Dena’ina Conference Center)					
7:00am - 5:00pm	Registration - <i>Dena’ina Convention Center, third floor</i>				
7:30am - 9:00am	Keynote Breakfast panel, “PNWER: The Energy Breadbasket of the Continent,” featuring Drue Pearce , Chair, Institute of the North, Former Alaska Senate President and the Honourable Ken Hughes , Minister of Energy, Alberta. Hosted by Spectra Energy - <i>Tikahtnu Ballroom BC, Dena’ina Center, third floor</i>				
9:15am - 11:45am	Energy I <i>Coffee break hosted by GCI</i>	Water Policy <i>Kahtnu 2</i>	Border Issues <i>Tubughnenq’ 3</i>	Innovation <i>Tubughnenq’ 4</i>	Health Care <i>Tubughnenq’ 5</i>
12:00pm - 1:30pm	Keynote Luncheon featuring Governor Sean Parnell , Alaska. Hosted by Puget Sound Energy - <i>Tikahtnu Ballroom BC, Dena’ina Center, third floor</i>				
1:45pm - 5:15pm	Energy II <i>Coffee break hosted by ASET</i>	Agriculture <i>Kahtnu 2</i>	Market Access <i>Tubughnenq’ 3</i>	Disaster Resilience <i>Tubughnenq’ 4</i>	Ocean and Coastal Caucus I <i>Tubughnenq’ 5</i>
5:15pm - 5:45pm	Arctic Caucus Brief-Out (All Summit Co-chairs invited) - <i>Tikahtnu D, third floor</i>				
6:00pm - 7:30pm	Light Reception and Fur Fashion Show. Hosted by Carlile Transportation – <i>Marriott Ballroom</i>				
7:30pm	Free Evening - Dinner on your own				
8:30pm - 11:00pm	Hospitality Suite hosted by The Government of Yukon - <i>Captain Cook, Club Room #1, 10th Floor</i>				

All Dena’ina breakout sessions are held on the second floor of the conference center. Please see the map on page 48

Wednesday, July 17th (All sessions at the Dena'ina Convention Center)

7:00am- 5:00 pm	Registration - Dena'ina Convention Center, third floor					
7:30am - 9:00am	Breakfast Keynote featuring Dr. David Lodge , University of Notre Dame presented by the Invasive Species Working Group. Hosted by HDR - <i>Tikahtnu Ballroom BC, Dena'ina Center, third floor</i>					
9:15am - 11:45am <i>Coffee break hosted by Princess Cruises</i>	Mining <i>K'enakatnu Board Room</i>	Cross-Border Livestock Health Conference <i>Kahtnu 2</i>	Invasive Species Conference <i>Tubughnenq' 3</i>	Transportation, Tourism and Border Joint Session: "The Inside Passage" <i>Tubughnenq' 4</i>	Ocean and Coastal Caucus II <i>Tubughnenq 5'</i>	
12:00pm -2:00pm	Keynote Luncheon featuring Denis Stevens , Consul General of Canada in Seattle and Anne Callaghan , U.S. Consul General in Vancouver. Moderated by Chris Sands , Senior Fellow, Hudson Institute. Hosted by Nelson Mullins - <i>Tikahtnu Ballroom BC, Dena'ina Center, third floor</i>					
2:15pm - 5:00pm <i>Coffee break hosted by NWGA</i>	Natural Gas as a Transportation Fuel <i>K'enakatnu Board Room</i>	Cross-Border Livestock Health Conference <i>Kahtnu 2</i>	Invasive Species Conference <i>Tubughnenq' 3</i>	Transportation, Tourism and Border Joint Session: "The Inside Passage" <i>Tubughnenq' 4</i>	Coastal and Ocean Caucus <i>Tubughnenq' 5</i>	Workforce <i>Tikahtnu D, third floor</i>
5:15pm - 5:45 pm	Arctic Caucus Brief-Out (All Summit Co-chairs invited), Tikahtnu D, third floor					
6:30pm - 9:00pm	Reception featuring Mayor Dan Sullivan , City of Anchorage. Hosted by Enbridge - <i>Alaska Native Heritage Center. Buses depart from the Marriott at 6:30 pm</i>					
9:00pm	Hospitality Suite hosted by APEGA, APEGS, and APEGBC - <i>Marriott Ballroom</i>					

Thursday July 18 (All sessions at Dena'ina)

7:00 am -10:00am	Registration - Dena'ina Convention Center, third floor					
7:30am- 9:00am	Keynote Breakfast Alaska Arctic Policy Commission Panel featuring Rep. Bob Herron , Alaska, and Sen. Lesil McGuire , Alaska. Hosted by ConocoPhillips, <i>Tikahtnu Ballroom BC, Dena'ina Center, third floor</i>					
9:15am- 11:45am <i>Coffee break hosted by TransCanada</i>	Energy Storage <i>K'enakatnu Board Room</i>	Cross-Border Livestock Health <i>Kahtnu 2</i>	Trade and Economic Development <i>Tubughnenq' 4</i>			
9:15am - 11:45 am	Policy Tour - Ted Stevens Anchorage International Airport. Meet at the registration table 10 minutes prior to departure					
9:15am - 11:45 am	Policy Tour - WJ Hernandez Hatchery Tour. Hosted by HDR. Meet at the registration table 10 minutes prior to departure					
12:00pm - 2:00pm	Keynote Luncheon featuring The Honourable Bob McLeod , Premier of the Northwest Territories, Lt. Governor Mead Treadwell , Alaska, and Patrick Borbey , President, Canadian Northern Economic Development Agency. Hosted by Croplife Canada and CBI Canada - <i>Tikahtnu Ballroom BC, Dena'ina Center, third floor</i>					
2:30pm - 5:00pm <i>Coffee break hosted by Anglo American</i>	Executive Committee Meeting <i>K'enakatnu Board Room</i>	Cross-Border Livestock Health <i>Kahtnu 2</i>				
2:30pm - 5:00pm	Policy Tour - North American Aerospace Defense Command (NORAD) at Elmendorf Air Force Base. Meet at the registration table 10 minutes prior to departure. Pre-registration required					

Friday, July 19

4:00am	Policy Tour - Nome Gold Rush Tour. Meet at the registration table 10 minutes prior to departure					
9:00am	Policy Tour - Pebble Mine. Hosted by Pebble Partnerships Meet at the registration table 10 minutes prior to departure					

Welcome to the 23rd Annual Summit!

2013 Summit Host Committee

Sen. John Coghill, Senate Majority Leader, Alaska State Senate	Wendy Lindskoog, <i>Vice President Business Management and Corporate Affairs, Alaska Railroad</i>
Sen. Fred Dyson, Alaska State Senate	Sharon Long, <i>Chief of Staff, Alaska State Legislature</i>
Rep. Bruce Edgmon, Alaska House of Representatives	Ben Mohr, <i>Public Affairs Specialist, Pebble Partnerships Ltd.</i>
Sen. Anna Fairclough, Alaska State Senate	Kara Moriarty, <i>Executive Director, Alaska Oil and Gas Association</i>
Sen. Cathy Giessel, Alaska State Senate	Anita Nelson, <i>Public Affairs Specialist, Princess Cruises</i>
Rep. Bob Herron, Alaska House of Representatives	Rachael Petro, <i>CEO, Alaska State Chamber of Commerce</i>
Sen. Charlie Huggins, President of the Senate, Alaska State Senate	Laura Pierre, <i>Legislative Staff, Alaska State Legislature</i>
Sen. Lesil McGuire, Alaska State Senate	Bill Popp, <i>President, Anchorage Economic Development</i>
Rep. Peggy Wilson, Alaska House of Representatives	Carl Portman, <i>Deputy Director, Resource Development Council (RDC)</i>
Nils Andreassen, Executive Director, <i>Institute of the North</i>	Amy Saltzman, <i>Legislative Staff, Alaska State Legislature</i>
Glee Anderson, Convention Services Manager, <i>Visit Anchorage</i>	Jordan Shilling, <i>Legislative Staff, Alaska State Legislature</i>
Portia Babcock, Director Government and Community Affairs, ConocoPhillips Alaska	John Shively, <i>CEO, Pebble Partnership Ltd.</i>
John Binkley, <i>President, Alaska Cruise Ship Association</i>	Jody Simpson, <i>Legislative Staff, Alaska State Legislature</i>
Jon Bittner, Vice President, Anchorage Economic Development Corp.	Tim Sullivan, <i>Corporate Affairs, Alaska Railroad</i>
Deantha Crockett, <i>Executive Director, Alaska Mining Association</i>	Cam Toohey, <i>Government Affairs Manager, Shell</i>
Rob Earl, <i>Chief of Staff, Alaska State Legislature</i>	Doanh Tri Tran, <i>Legislative Staff, Alaska State Legislature</i>
Cathy Foerster, <i>Commissioner, Alaska Oil and Gas Commission</i>	Patricia Walker, <i>Legislative Staff, Alaska State Legislature</i>
Robert Gerlach, <i>VMD, Alaska State Veterinarian, State of Alaska</i>	Susan Wallin, <i>Legislative Staff, Alaska State Legislature</i>
Debra Higgins, <i>Rules Committee Aide, Alaska State Legislature</i>	Lindsay Williams, <i>Legislative Staff, Alaska State Legislature</i>

Bold = Sub-committee Lead

We are honored to host the Pacific NorthWest Economic Region's 23rd Annual Summit in our state. As the host committee, we would like to extend a warm Alaskan welcome to all delegates. In addition to providing a forum for thoughtful dialogue and relationship-building, our goal for the summit is to introduce you to the very best of The Last Great Frontier.



Sen. Lesil McGuire
Alaska State Senate
Host Committee Co-Chair

The theme of this year's Annual Summit, "The future of The North: Opportunities, Challenges and Regional Solutions," reflects PNWER's commitment to better understanding and addressing challenges, both geographical and environmental, of doing business in the Arctic. Here at the Summit, we bring you an opportunity to join a dialogue with stakeholders who live, work and play here. Our collaborative approach across sectors and borders will help create a strong future for the Arctic, a crucial area for our region, as well as the world, because of its vast natural resources and opportunity.

Take in the majestic natural surroundings, as well as our way of life, with one of our many policy tours. The 26 Glacier Cruise is the best networking event of the Summit. Come enjoy awe-inspiring glaciers and Alaskan wildlife while you network with your fellow PNWER participants. Other great policy tours may still be available.

The Annual Summit is a chance to share best practices and incite discussion on the policy challenges facing the region. This summit is a platform to discuss the Beyond the Border action plan, energy security, natural resource development, trade issues and many others.

After the busy days of working group session, please join us at our relaxing receptions and hospitality suites. Our Wednesday reception at the Alaska Native Heritage Center will give you a glimpse into the rich history and culture of the first inhabitants of our state.

The success of this summit will be a direct result of the people that PNWER brings together and the discussions that develop. We look forward to your partnership in helping to ensure that the PNWER Annual Summit leaves a lasting impression.

Sincerely,

The Alaska Host Committee

Welcome from the PNWER President



Hon. Lyle Stewart
PNWER President
2012-2013

Welcome to the 23rd Annual Summit. We are delighted to welcome you to Anchorage, and beautiful Alaska! Your participation during the Annual Summit is central to PNWER's ongoing efforts to improve understanding, growth, and cooperation across the bi-national region PNWER represents. Thank you for coming; it is sure to be an excellent event!

This region is unparalleled in the world in terms of energy, natural resources, agricultural productions, and the trade and export facilitates that serve both our countries. We are also fortunate to be a region of skilled, resourceful, and innovative people. Through events like the Summit, we can better work together—sharing ideas, challenges, successes, and failures to make the region stronger and more resilient and creating opportunities for our shared future. I hope you will take advantage of this opportunity to build partnerships and plans for the future through the Summit sessions and networking events. The topics within the agenda aim to bring forward the important issues facing each of our member states, provinces, and territories.

I have been honoured to serve as President of PNWER for the past year, and I thank the PNWER members for this opportunity. Following are some of the highlights that I have been proud to see the organization accomplish throughout the year:

- PNWER kicked off 2013 with visits to four of the region's capitals, and brought delegations to the federal capitals of each country. We had the excellent opportunity during our trips to Washington D.C. and Ottawa to discuss the Region's concerns with our federal Ministers and Congressmen and Senators in both national capitals.
- PNWER has continued to provide input from regional stakeholders to both federal governments for the Beyond the Border Initiative and Regulatory Cooperation Council announced by President Obama and Prime Minister Harper in February, 2011. As a part of this initiative, PNWER was tasked with the development of the US-Canada Maritime Commerce Resilience Initiative to increase the resilience of regional maritime supply chains by improving the process for swiftly managing maritime traffic in the event of an emergency.
- Together with our partners, including the University of Idaho, US Department of Energy, and Natural Resources Canada, PNWER expanded the Legislative Energy Horizon Institute (LEHI) certificate program from a two-year course, to an annual program. This program is designed for legislators to understand how the region's energy infrastructure functions, and is a great example of how PNWER has been proactive to fill an important need. The 3rd LEHI class commenced on July 5-9, 2013 in Richland, Washington. They will graduate this coming October in Washington, D.C.
- PNWER hosted the 2013 Economic Leadership Forum in Coeur d'Alene, Idaho. This meeting was developed with the help of the new PNWER Idaho Council. The Idaho Council aims to increase Idaho's involvement in PNWER activities and increase participation of the Idaho private sector and executive branch. Looking forward, we hope to increase PNWER's effectiveness by encouraging the creation of state and provincial councils throughout the region.

These are only some of the many initiatives you will hear about in the next few days here in Anchorage. I encourage you to take part in any of the excellent working groups taking place this week--Please take the opportunity to expand your knowledge of a new topic, or lend your expertise to one of the discussions. We thank you for your involvement and leadership- It's the support of our Sponsors, the Host Committee and the participants that makes the Summit such a success each year.

I look forward to meeting you this week in Anchorage!

Sincerely,

A handwritten signature in black ink, appearing to read 'Lyle Stewart'.

Hon. Lyle Stewart, MLA for Thunder Creek and Minister of Agriculture, Saskatchewan
PNWER President, 2012- 2013

PNWER is the preeminent bi-national advocate for regional state, provincial, and territorial issues

The Pacific NorthWest Economic Region (PNWER) is a public-private partnership chartered by the states of Alaska, Idaho, Montana, Oregon, and Washington; the western Canadian provinces of Alberta, British Columbia, and Saskatchewan; and Yukon and the Northwest Territories. PNWER is dedicated to encouraging global economic competitiveness and preserving our world-class natural environment. PNWER is recognized by both the United States and Canada federal governments as the “model” for regional and bi-national cooperation because of its proven success. PNWER is a respected voice and resource for our region. It provides the public and private sectors a cross-border forum for unfiltered dialogue that capitalizes upon the synergies between business leaders and elected officials working to advance the region’s global competitiveness.



Members of PNWER’s capital visit delegation meet with Alaska Governor Sean R. Parnell at the Alaska State Legislature in Juneau on January 19, 2013.

The Region’s Future

With over \$1 trillion (USD) in gross regional product, the U.S. Pacific Northwest and Western Canada is one of the fastest growing regions of North America. This region is China’s and East Asia’s gateway to North America, and is home to several major infrastructure projects and business opportunities. Now, more than ever, the Pacific Northwest needs a bi-national, regional advocate that works with both the public and private sectors.

Public and Private Sector Leadership

PNWER delivers results on regional issues through action plans developed within 20 working groups that correspond to the region’s key priorities. Each working group is co-chaired by an industry leader and a government representative. PNWER is a forum for collaborative bi-national planning involving both the public and private sectors and offers leadership at the state/provincial/territorial level in Oregon, Washington, Idaho, Montana, Alaska, Alberta, British Columbia, Saskatchewan, Yukon and Northwest Territories, and at the national level in Washington, D.C. and Ottawa.

2012 Executive Committee Officers



Hon. Lyle Stewart
President
Saskatchewan



Sen. Kevin Ranker
Vice President
Washington



Hon. David Ramsay
Vice President
Northwest Territories



Sen. Curt McKenzie
Vice President
Idaho

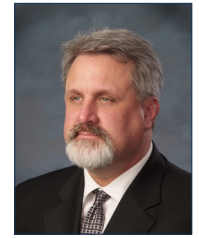

Rep. Mike Schaufler
Imm. Past President
Oregon

Jurisdiction Leads

- Sen. Lesil McGuire
Alaska
- Ms. Alana DeLong, MLA
Alberta
- Mr. Norm Letnick, MLA
British Columbia
- Sen. Cliff Larsen
Montana
- Hon. Currie Dixon
Yukon

PRIVATE SECTOR REPRESENTATIVES

- Colin Smith APEGBC
Canada Co-Chair
- Dan Kirschner, NWGA
US Co-chair

Bold = State/Provincial Lead

PNWER Staff

- Matt Morrison
Executive Director
- Brandon Hardenbrook
Deputy Director
- Steve Myers
Program Manager
- Eric Holdeman
Director, Center for
Regional Disaster
Resilience (CRDR)
- Megan Levy
Program Coordinator
- Gabrielle Nomura
Communications and
Media Coordinator
- Joe Larsen
Program Coordinator
- Jennifer Grosman,
Program Coordinator

Delegate Council

- ALASKA**
Gov. Sean Parnell
Sen. Berta Gardner (Alt)
Sen. Cathy Giessel (Alt)
Sen. Lesil McGuire
Rep. Bob Herron
Rep. Doug Isaacson (Alt)
Rep. Charisse Millett (Alt)
Rep. Peggy Wilson

- ALBERTA**
Premier Alison Redford
Alana DeLong, MLA
Len Webber, MLA
Peter Sandhu, MLA
Dr. Richard Starke, MLA

- BRITISH COLUMBIA**
Premier Christy Clark
Norm Letnick, MLA
Simon Gibson, MLA
Laurie Throness, MLA

- IDAHO**
Gov. C.L. Butch Otter
Rep. Eric Anderson (Alt)

Private Sector Council*

- ALASKA**
Paul Quesnel, *BP*
Cam Toohey, *Shell*
Portia Babcock, *ConocoPhillips*
Donna McCray, *ExxonMobil*

- ALBERTA**
Doug Bloom, *Spectra Energy*
Dwain May, *Capital Power*
Jeff Gaulin, *Tervita*
Sonya Savage, *Enbridge*
Scott Thon, *AltaLink*
Peter Kruselnicki, *TransCanada*
Bryan Maynard, *Marathon*
Mark Flint, *APEGA*

- BRITISH COLUMBIA**
Don Dalik, *Fasken Martineau*

- Rep. George Eskridge
Sen. John Goedde (Alt)
Rep. Hy Kloc (Alt)
Sen. Curt McKenzie
Rep. Elaine Smith
Sen. Michelle Stennett (Alt)
Sen. Elliot Werk

- MONTANA**
Gov. Steve Bullock
Rep. Edie McClafferty (Alt)
Rep. Mike Cuffe
Sen. Jeff Essmann (Alt)
Sen. Cliff Larsen
Sen. Mike Phillips (Alt)
Sen. Chas Vincent
Rep. Jeff Welborn (Alt)
Rep. Kathleen Williams

- THE NORTHWEST TERRITORIES**
Premier Bob McLeod
Hon. David Ramsay
Robert Hawkins, MLA

- OREGON**
Gov. John Kitzhaber
Rep. Deborah Boone
Rep. Kevin Cameron (Alt)

- Jason Wolfe, *FortisBC*
Colin Smith, APEGBC

- IDAHO**
Roy Eiguren, *Eiguren*
Russ Hendricks, *Idaho Farm
Bureau*
Tom Power, *Sunshine Minting*
Ron Nilson, *Ground Force
Worldwide*

- MONTANA**
Haley Beaudry, *Columbia Falls
Aluminum Co.*

- OREGON**
Dan Kirschner, NWGA
Sunny Radcliffe, *PGE*
David Cobb, *HDR*

- Rep. Bill Kennemer
Sen. Rod Monroe (Alt)
Sen. Arnie Roblan
Rep. Brad Witt (Alt)
Sen. Doug Whitsett (Alt)
Sen. Bill Hansell
Rep. Brad Witt (Alt)

- SASKATCHEWAN**
Premier Brad Wall
Hon. Bill Boyd
Dustin Duncan, MLA
Hon. Lyle Stewart
Herb Cox, MLA

- WASHINGTON**
Gov. Jay Inslee
Sen. Barbara Bailey (Alt)
Sen. Maralyn Chase (Alt)
Sen. Jim Honeyford
Sen. Kevin Ranker
Rep. Bruce Chandler
Rep. Gael Tarleton
Rep. Norm Johnson (Alt).

- YUKON**
Premier Darrell Pasloski
Hon. Currie Dixon

- THE NORTHWEST TERRITORIES**
Chuck Parker, *Discovery Air*

- SASKATCHEWAN**
Dennis Paddock, *APEGS*
Scott Rudderham, *Canpotex*
Lionel LaBelle, *STEP*

- WASHINGTON**
William Kidd, *BP*
Nancy Atwood, *PSE*
DeLee Shoemaker, *Microsoft*
Roger Woodworth, *Avista*

- YUKON**
Don Pumphrey, *NorthwestTel*

* Partial Listing

Keynote Speakers



Patrick Borbey was appointed President of the Canadian Northern Economic Development Agency (CanNor) in December 2011. In March 2013 Mr. Borbey was appointed Chair of the Arctic Council's Senior Arctic Officials (SAO) for Canada's two-year term as Chair of the Arctic Council, which will extend from May 2013 to May 2015. As SAO Chair, Mr Borbey will work closely with senior Arctic officials from the eight Arctic states that comprise the Arctic Council, as well as with the heads of the Council's six Indigenous Permanent Participants, in managing the Arctic Council's activities. Prior to joining CanNor, Mr. Borbey held the positions of Senior Assistant Deputy Minister of Treaties and Aboriginal Government and Assistant Deputy Minister of Northern Affairs at Aboriginal Affairs and Northern Development Canada. He also held senior positions at the Department of Labour and at Industry Canada. Originally from Elliot Lake in Northern Ontario, Mr. Borbey holds a Bachelor of Arts in Social Sciences (concentration in Political Science) and a Master of Business Administration from the University of Ottawa.



Anne Callaghan assumed duties as the United States' Consul General in Vancouver on August 25, 2011. Anne Callaghan is a career senior Foreign Service officer with the U.S. State Department, with the personal rank of Minister Counselor. Before her assignment as Consul General in Vancouver, she was posted in southeastern Iraq, overseeing the Maysan Provincial Reconstruction Team in its last year of operation. Ms. Callaghan has also served as Minister Counselor for Public Affairs in Rome where she directed public diplomacy for the U.S. Embassy and three Consulates General (2006-2009); and as Counselor for Public Affairs in Bogota, Colombia (2004-2006). Her last Washington tour was in the senior assignments division of the Bureau of Human Resources (2009-2010). Ms. Callaghan joined the Foreign Service with the U.S. Information Agency in 1984. Prior to entering the Foreign Service, Ms. Callaghan worked at the Center for Research in International Studies at Stanford University. A native of New Jersey, she received her undergraduate degree in East Asian Studies from Colby College and graduate degrees from the University of Michigan.



Ken Hughes was elected as a Member of the Legislative Assembly of Alberta for the constituency of Calgary-West on April 23, 2012. Mr. Hughes holds an undergraduate degree in agriculture from the University of Alberta. He also has a master's in public administration from the John F. Kennedy School of Government at Harvard University (1981-1983) with a focus on public and corporate finance. Mr. Hughes is an entrepreneur and the founder of the insurance brokerage firm Alpine Insurance & Financial, Inc., with offices across Alberta. As a successful businessman Mr. Hughes is keenly aware of how the ebb and flow of the economy affects Alberta families. Mr. Hughes is a certified director (ICD.D) and has worked in several business sectors, including property and casualty insurance, energy and energy services and information technology. Mr. Hughes and his wife, Denise, have three children.

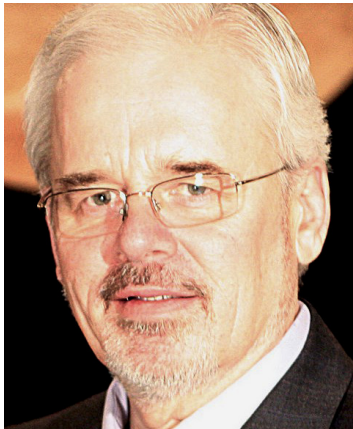

Rep. Bob Herron, Alaska State Legislature, serves as the Alaska State Representative for House District 37 - 32 communities in the South Bering Sea region that includes the Kuskokwim Bay, Western Bristol Bay, Alaska Peninsula, Aleutian Chain, Bering Sea Islands & Bethel. From his home community of Bethel to Attu is a distance of 1,700 miles. First elected in 2008, then again in 2010 and 2012, he currently co-chairs the Alaska Arctic Policy Commission and currently serves on the Labor & Commerce, Community & Regional Affairs, Economic Development-Tourism-Trade committees with Finance subcommittee assignments for the Departments of Transportation & Corrections and is a member of the Alaska Bush Caucus and Veterans' Caucus. Previous career opportunities include seven years as the Bethel City Manager and staffing the Alaska Congressional Delegation.



John Higginbotham is a senior fellow at The Centre for International Governance Innovation. An expert in maritime, air, road and rail transportation systems and governance and international relations, he is leading CIGI's global security research project on the Arctic. John is also a senior distinguished fellow at Carleton University, where he has been working on the Arctic, China and the United States as well as a transport studies initiative drawing on the strengths of Carleton's faculties of Business, Public Administration and Engineering. His work with the Government of Canada, including several international assignments, spans over twenty years. He served as assistant deputy minister in three departments, including Transport Canada where he coordinated Canada's highly successful Asia-Pacific Gateway and Corridor Initiative. John served as vice president at the Canada School of Public Service, focusing on Canada-US relations, and as assistant deputy minister for policy planning, communications, culture and federal-provincial relations at Foreign Affairs and International Trade.



Teresa Imm has served the company for 23 years as an in-house advisor on all matters related to oil, gas, coal, base-metal materials and gravel exploration, development and management of ASRC's nearly 5 million acres. In this role, she is responsible for balanced resources development strategies that reflect the traditional and cultural values of the corporation's shareholders and their ties to the land. She is the current president of ASRC Exploration LLC, where she manages ASRC investments in exploration and production in oil and gas properties. Imm also serves as the president of ASRC Pipeline Company Inc. ASRC is the largest locally-owned and operated business in Alaska, with revenues in excess of \$2.3 Billion and more than 10,000 employees worldwide. Imm serves on the board of directors for the Resource Development Council, and was the past president of Alaska Resource Education (formerly Alaska Mineral and Energy Resource Education Fund), a partnership between the Alaska Department of Education and private industry.



David Lodge is a professor and Director of the Environmental Change Initiative at Notre Dame University. One of the world's leading experts on aquatic invasive species, professor Lodge is the founder, architect and visionary behind the multidisciplinary and public policy thrust that drives much of the work at ND-ECI. His research focuses on ecological forecasting to better inform environmental risk assessment, policy development, and natural resource management. On numerous occasions Lodge has testified before the U.S. Congress about invasive species, and has also served as an expert witness in federal court. He served as the first chair of the U.S. government's national Invasive Species Advisory Committee in 2000-01, led research on freshwater biodiversity as part of the Millennium Ecosystem Assessment sponsored by the United Nations in 2000-05, and led an expert team providing advice to the U.S. Environmental Protection Agency on reducing invasions from the ballast water of ships in 2010-11.



Senator Lesil McGuire is actively involved in national and international legislative leadership organizations as well where she fights to ensure Alaska's issues are represented. For example, during her term as the President of Pacific NorthWest Economic Region (PNWER) she established an "Arctic Caucus" to bring together the Yukon, Northwest Territories and Alaska to collaborate on resource development in the Arctic. Lesil is also the past Chair of the Council of State Governments-WEST, an alumnae of CSG-West's Western Legislative Academy and the Henry Toll Fellowship with the Council of State Governments. Lesil McGuire grew up with those she now represents in the Alaska State Legislature. Following her undergraduate studies, she went on to work in Washington D.C. for two years as a legislative and press aide for United States Senator Ted Stevens. She subsequently obtained her Juris Doctorate from Willamette University College of Law while clerking in the United States Attorney's Office in Oregon.

Keynote Speakers



Senator Lisa Murkowski is the first Alaskan-born Senator and only the sixth United States Senator to serve the state. The state's senior senator, Lisa Murkowski is a third-generation Alaskan, born in Ketchikan and raised in towns across the state: Wrangell, Juneau, Fairbanks and Anchorage. Since joining the Senate in 2002, Senator Murkowski has been a strong advocate for Alaska on the important issues facing the state, including energy, health care, education, military/veterans' affairs and infrastructure development. Only the 33rd female to serve in the United States Senate, Senator Murkowski has assumed leadership roles quickly. She is the senior Republican member of the Senate Energy and Natural Resources Committee and also serves on the Senate Appropriations Committee, where she is the ranking Republican of the Interior and Environment Subcommittee. She earned a B.A. in economics from Georgetown University in 1980 and a law degree from Willamette University in 1985. Prior to her appointment to the United States Senate, Senator Murkowski practiced commercial law in Anchorage and served three terms in the Alaska State House of Representatives.



Governor Sean Parnell assumed office in July of 2009 and has since focused on growing Alaska's economy and strengthening families. Governor Parnell advances Alaskans' interests by adhering to our state's constitutional priorities: resource development, education, public safety, and infrastructure. The governor aggressively works to make Alaska competitive for economic growth by lowering taxes, streamlining regulations, and building infrastructure. In 2009, Governor Parnell successfully worked with the Legislature to establish the Alaska Performance Scholarship. Governor Parnell has also taken on the challenge to end the epidemic of domestic violence and sexual assault in Alaska. Governor Parnell moved to Alaska in 1973. Parnell earned a bachelor's of business administration from Pacific Lutheran University, and a Juris Doctorate from the University of Puget Sound School of Law.



Druce Pearce is a senior policy adviser with Crowell & Moring's Environment, Energy & Resources and Government Affairs groups. She provides strategic legislative and regulatory advice to a wide variety of natural resources, manufacturing and energy clients as they navigate government relations, as well as legal and regulatory issues at the various state and federal agencies with jurisdiction over resource development projects. Ms. Pearce brings a wealth of experience on energy, environment, economic security and natural resources issues in North America, and specifically in Alaska and Canada. She has more than 25 years of experience in government affairs, public relations, natural resources and energy policy and regulation, having served in the Alaska State Legislature, the private sector, and in the Immediate Office of the Secretary at the Department of the Interior and at the Office of the Federal Coordinator for Alaska Natural Gas Transportation Projects.



Crawford Patkotak (Ahkivgak) currently serves as the chairman of the board for Arctic Slope Regional Corporation as well as the senior vice president of Shareholder and Community Programs and board president of Eskimo's Inc. Arctic Slope Regional Corporation is the largest locally-owned and operated business in Alaska, with revenues in excess of \$2.5 billion and more than 10,500 employees worldwide. Crawford has been the whaling captain for the Patkotak Crew since 2008 and has been recently elected as a board member for the Barrow Whaling Captains Association. Crawford has participated in various organizations in the past such as a council member for the City of Barrow, board of trustee for Ilisagvik College and a board member for Barrow Utilities & Electric Cooperative Inc. Crawford grew up in Barrow and Peard Bay, hunting and gathering, and explores the land and hunts for fur animals in the winter and summer months around the Arctic Slope Region. Crawford enjoys taking his family on trips by air, land and sea. Crawford currently lives in Barrow with his wife Laura and their 6 children. He also has four grandchildren.



Alice Rogoff is publisher and owner of Alaska Dispatch. From 1985 to 1997, she was chief financial officer of U.S News and World Report. She served at The Washington Post Co. as assistant to publisher Donald Graham, and she was the creator of the Post's National Weekly Edition. Earlier in her career she served in President Jimmy Carter's administration as special assistant to director of the U.S. Office of Management and Budget. Alice is also the founder of Arctic Imperative, a lecture series dedicated to raising awareness of circum-polar north issues. And she is co-founder of a number of other organizations, including the Alaska Native Arts Foundation. One of her duties as Dispatch's publisher is piloting her Cessna 206 in search of great stories and photos around Alaska.



Christopher Sands is the G. Robert Ross Distinguished Professor of Canada-U.S. Business and Economic Relations in the College of Business and Economics and a research fellow of the Border Policy Research Institute at Western Washington University in Bellingham, WA. He is also a senior fellow of the Hudson Institute in Washington, DC where he directs the Hudson Initiative of North American Competitiveness. He is also a lecturer in Canadian studies at the Johns Hopkins University School of Advanced International Studies (SAIS) and adjunct professor in Government at the American University School of Public Affairs. He serves on advisory boards for the Canada-United States Law Institute, the Macdonald-Laurier Institute, and as treasurer for the Canadian Politics Section of the American Political Science Association. Originally from Detroit, Michigan he thinks that the United States won the War of 1812 but that Detroit clearly lost.



Hugh Short is currently the CEO for Platinum Capital Advisors, LLC. He is a lifelong Alaskan has served as the VP for Support Services at the Yukon Kuskokwim Health Corporation, as well as owner of small businesses in rural Alaska. Additionally, he has served as the Mayor of Bethel from 2002 to 2004, and the Yuut Elitnaurviat Board of Directors in Bethel, Alaska. Hugh currently serves on the Board of Directors for the Alaska Humanities Forum as Treasurer, Pacific Northern Academy as Treasurer, Rural Energy Enterprises, and United Utilities, Inc. Hugh was born and raised in Bethel, Alaska and is a Calista Corporation shareholder.



Denis Stevens was appointed Consul General of Canada in Seattle by Prime Minister Stephen Harper in August 2010. He is Canada's senior representative in the Pacific Northwest, which includes the states of Alaska, Idaho, Oregon and Washington. Mr. Stevens hails from Montreal. He has served with the Canadian government for 17 years, 10 of them in management positions in the departments of Justice; Indian and Northern Affairs; Public Safety and at the Privy Council Office, the department that serves the Prime Minister and the Cabinet. Immediately prior to his appointment, Mr. Stevens served as Director General for Intergovernmental Relations and Public Outreach at the Department of Foreign Affairs and International Trade. Mr. Stevens earned his Bachelor of Arts degree in International Relations with great honors in 1988 from Harvard University. He earned his law degree and Masters of Business Administration from McGill University in 1992.

Keynote Speakers



Mayor Dan Sullivan was first elected in 2009 and is currently serving his second and final term as Mayor of the Municipality of Anchorage. Dan was born and raised in Alaska, graduated from West Anchorage High School and received his bachelor's degree in political science from the University of Oregon. From 1998 to 2008, he served the maximum of three consecutive terms on the Anchorage Assembly. Dan is the founder and co-owner of McGinley's Pub in downtown Anchorage and has been a small business owner for nearly 30 years. Dan was also the Executive Director of the highly successful 1996 Arctic Winter Games, held in Anchorage. His wife, Lynnette, is an award-winning elementary school teacher and their daughter Jennifer graduated with honors from the Anchorage School District and from the University of Oregon's Clark Honors College in 2009.



Mead Treadwell was elected as Alaska's lieutenant governor in November 2010. He is committed to helping Governor Sean Parnell strengthen Alaska's economy by filling the TransAlaska Pipeline, facilitating a gas pipeline, bringing affordable energy to Alaskans and standing up to the federal government to ensure access to our natural resources. On a national level, he has been influential in bringing about a national missile defense system, in shaping U.S. Arctic policy and in establishing circumpolar cooperation. A graduate of Yale University and the Harvard Business School, Treadwell brings a record of private and public sector success to his job as lieutenant governor. Lt. Governor Treadwell is recognized as one of the world's Arctic policy experts. Treadwell was appointed to the United States Arctic Research Commission by President George W. Bush in 2001 and designated by the president as the commission's chair in 2006. Under his leadership, a new United States Arctic policy was developed and adopted by President Bush and is now being implemented by the current administration. With his late wife Carol, he has three children.



The PNWER Delegation of Executive Officers at the Capitol in Ottawa, June, 2013.

SUNDAY, JULY 14

SUNDAY, JULY 14

11:30am - 6:00pm	Registration <i>Marriott second floor foyer</i>	
12:00pm - 1:00pm	Executive Board Lunch (Invitation only) <i>Denali Room, Marriott</i>	
1:00pm - 5:00pm	Executive Committee Meeting <i>Kenai Room, Marriott</i>	
6:00pm - 8:00pm	Opening Reception Featuring a keynote address by U.S. Senator Lisa Murkowski <i>Marriott Ballroom</i>	Hosted by ExxonMobil
9:00pm	Hospitality Suite <i>Crow's Nest Suite, 19th Floor, Hotel Captain Cook</i>	Hosted by BP

MONDAY, JULY 15

MONDAY, JULY 15

7:00am - 5:00pm	Registration <i>Marriott second floor foyer</i>	
7:30am - 9:15am	Opening Breakfast <i>Marriott Ballroom</i>	
	<p>"Arctic Challenges and Opportunities," featuring John Higginbotham, <i>Senior Distinguished Fellow</i>, Carleton University; Hugh Short, <i>CEO</i>, Platinum Capital Advisors; Crawford Patkotak, <i>Chairman</i>, Board of the Arctic Slope Regional Corporation; and Teresa Imm, <i>Vice President of Resource Development</i>, Arctic Slope Regional Corporation. Moderated by Alice Rogoff, <i>Publisher and Owner</i>, Alaska Dispatch Publishing</p> <p>Please wear your cruise apparel and bring your camera for the Glacier Cruise with you to breakfast</p>	
9:30am - 5:30pm	26 Glaciers Cruise A unique networking opportunity where delegates will journey along Alaska's beautiful coast and glaciers in Prince William Sound. Pre-registration required. Buses depart the Marriott promptly at 9:30am. Please bring your camera and coat with you to breakfast. Please bring the ticket included in your registration packet. Cruise participants will travel directly to the Alyeska Resort after the cruise	
6:00pm - 8:30pm	Reception <i>Alyeska Resort, Columbia Ballroom, Girdwood, Alaska</i> Transportation provided from the Marriott and the 26 Glaciers Cruise. Buses depart from the Marriott at 5:30pm	Hosted by Shell

7:00am - 5:00pm

Registration - Dena'ina Conference Center, third floor

7:30am - 9:00am

Keynote Breakfast

“PNWER: the Energy Breadbasket of the Continent,” featuring **Drue Pearce**, Chair, Institute of the North, Former Alaska Senate President and the **Honourable Ken Hughes**, Alberta Minister of Energy.
Hosted by Spectra Energy

9:15am -11:45pm

Concurrent Sessions at the Dena'ina Conference Center

Coffee break hosted by GCI

Session I

9:15am - 11:45am

Co-Chairs:

Sen. Cliff Larsen,
Montana

Rep. Charisse Millett,
Co-Chair, Alaska House of
Representatives Special
Committee on Energy

Energy I

K'enakatnu Board Room

Overview of Alaska's Petroleum Resources: Prudhoe Bay and Outer Continental Shelf Development in the Arctic

- **Drue Pearce**, Chair, Institute of the North, Former Alaska State Senate President, current Senior Policy Advisor, Crowley & Moring LLP, Washington, DC

“The great potential of Alberta's energy resources and the concrete actions taken by the government to add value to achieving North American energy security.”

- **Al Sanderson**, Chief Assistant Deputy Minister, Strategy Division, Alberta Energy

Expanding International Markets for LNG

- **Larry Persily**, Federal Coordinator, Alaska

What is the scale and scope of the resource potential in Western Canada? Who are the players? What does Canada need to do to realize these opportunities?

- **Gary Weilinger**, VP, External Affairs, Spectra Energy

Hydraulic Fracturing: Rewards, Risks, & Regulations

- **Barry Penner**, QC, Senior Counsel, Davis, LLP, and former Environment Minister and Attorney General, British Columbia

What are the environmental concerns? How are governments responding? Could this response impact global investments? What are the implications for our region?

Discussion and Development of Action Items

1. How do we pay for the infrastructure to develop our resources?
2. Is there sufficient labor supply?
3. Is our environmental regulatory process sufficient to safeguard public safety and the environment?

Session II

9:15am - 11:45am

Co-Chairs:

David Hill, Director;
Centres and Institutes
and Research Advocacy,
University of Lethbridge

Rep. Bruce Chandler,
Washington

Water Policy

Kahtnu 2

Alaska's Water Landscapes: *Are We Missing the Boat?*

In Alaska, contrary to popular belief, water has become the key determinant governing future arctic development and economic trajectories. As increased international attention becomes focused on the extraction of natural resources, we anticipate increased conflicts due to a lack of arctic-wide comprehensive water policy. To address this critical gap and as a first step toward a comprehensive water policy we developed the Arctic Water Resources Vulnerability Index (AWRVI). The final output from AWRVI is a Resilience Dashboard which allows local to regional scale assessments of freshwater status for the purpose of better informing policy-making and management.

Session II
Continued - Water Policy

- **Lilian Na'ia Alessa**, *Director*, The Resilience and Adaptive Management Group and Project Director, The Alaska Experimental Program to Stimulate Competitive Research (EPSCoR); University of Alaska Anchorage,
- **Mark Myers**, *Vice Chancellor for Research and Principal Investigator*, The Alaska Experimental Program to Stimulate Competitive Research (EPSCoR); University of Alaska Fairbanks

Water Value, Water Charges and Water Prices

The World Economic Forum (WEF) has asked a group of experts from academia, national governments, international organizations and the private sector to develop paths for treating successfully with water issues, particularly when it comes to water values, charges and prices. The discussion is still on-going. However, it is already obvious that many of the ideas and concrete action proposals are of high value to the jurisdictions in the PNWER region. This presentation will present the state of the discussion and the potential importance of some lessons learned for the PNWER region.

- **Alexander J.B. Zehnder**, *Director of Water Resources*, Alberta Innovates – Energy and Environment Solutions (AI-EES) Edmonton Alberta, *Visiting Professor*, Nanyang Technological University, Singapore, and Chairman Triple Z Ltd, Zurich Switzerland
- Panel Discussion (OPEN)

The potential impact of Quagga and Zebra mussels on water systems and management across the region.

- **Dr. Mark Sytsma**, *Associate Vice President for Research*, Portland State University

Next Steps and Discussion

- Discussion of a workshop to provide updates on the activities around the Columbia Basin Treaty at a future PNWER gathering
- Development of a meeting of PNWER based research universities with a focus on water and water policy as the beginning of new collaborations to tackle existing and emerging water issues. We will work collectively to develop an agenda of high priority issues requiring the benefit of scientific research, analysis and synthesis and then work to coordinate activities and find new cross border opportunities for research collaboration. To get this going, the University of Lethbridge will take the initial lead.

Action items

Session III
9:15am - 11:45am

Co-chairs:
Dr. Don Alper, Director,
Border Policy Research Institute,
Western Washington University

Hon. Rob Merrifield, MP
Yellowhead, Chair of International
Trade Committee in the House of
Commons, Ottawa

Border Issues

Tubughnenq 3

How to maintain momentum for the Beyond the Border process to help create a streamlined 21st century border to benefit the North American economy?

Status of the Beyond the Border Action Plan: Updates from Canada and U.S. officials

- **Anne Callaghan**, *Consul General*, U.S. Consulate General Vancouver
- Hon. **Rob Merrifield**, *MP* Yellowhead, *Chair* of International Trade Committee, House of Commons, Ottawa
- **Deborah Meyers**, *Director*, *Canadian Affairs*, Office of International Affairs, Policy Directorate, U.S. Department of Homeland Security
- **Andrew Brown**, *Senior Policy Advisor*, Privy Council Canada

Private Sector Panel: What are the next steps necessary to ensure the border as a facilitator of commerce? Featuring: **Jeanette Patell**, *Government Affairs and Policy Leader*, GE Canada; **Brad Severin**, *Chair*, Alberta Chamber of Commerce; **Greg Wirtz**, *President*, North West & Canada Cruise Association; **Mike Nikolaisen**, *British Columbia Association of Cattle Feeders*; **Margaret Stock**, *Esq.*, Lane Powell LLC

Roundtable Discussion and Development of Action Items

Session IV
9:15am - 11:45am

Co-Chairs:

Alana DeLong, MLA, Alberta

Dave Zepponi, President, Northwest Food Processors Association

Innovation
Tubughnenq 4

Non-traditional Concepts for Intellectual Property (IP): *How can the Region Inspire Collaboration on Research and Development?*

- IP Challenges and ideas for greater collaboration on research that benefits the region.
- How Innovation Policy can impact the development and commercialization of IP
 - **Stephen Mooney**, *Director*, Cold Climate Innovation, Yukon Research Centre
 - **Dr. Mark Myers**, *Vice President of Research*, University of Alaska-Fairbanks
 - **Doug Naimo**, *Triggerfinger Software*

Open dialogue with participants on IP ideas for policy makers. *What collaborative concepts have been implemented around the region and how have they performed?*

Action items

Session V
9:15am - 11:45am

Co-Chairs:

Rep. John Rusche, Minority Leader, Idaho House of Representatives

Jessica Wolfe, Director, State Government Affairs, Allergan

Health Care
Tubughnenq 5

Panel: Tele-health to rural communities in the Arctic and beyond
The implementation of new technologies brings challenges and many opportunities. Several states and provinces are moving toward developing enhanced tele-health programs to reach and better serve rural communities. *How can we learn from existing programs and work toward developing tools and templates to assist regional partners in expanding these programs? What are key lessons learned involving policy, reimbursement and access to technology?*

- **Nancy Green**, *Managing Principal*, Verizon Health care, Verizon Enterprise Solutions
- **Stewart Ferguson**, *Chief Information Officer* of the Alaska Native Tribal Health Consortium and President of the American Telemedicine Association
- **John Sproule**, *Executive Director for Policy* with the Office of the Alberta Minister of Health

“U.S.-Canada cooperation in combating counterfeit and illegal pharmaceuticals”
Importation of prescription drugs is becoming a growing problem where foreign pharmacies, traders or suppliers, ship pharmaceuticals, which may or may not have been approved for use, into the U.S. or Canada without registering them through licensed supply chains. The goal of this discussion will be to explore ways that the US States and Canadian provincial government can address importation on the local level to ensure drug supply security and consumer protections.

- **Bryan Smith**, *Counsel*, Allergan Inc.

“The economic and community health benefits of conducting research trials in our region.” The Pacific Northwest is home to some of the most advanced research in the world. How are clinical trials benefiting the regional economy as well as patients in the region?

- **Todd Myers**, *Public Relations*, PhRMA

Action items

12:00pm - 1:30pm

Luncheon Keynote
Featuring Keynote, **Governor Sean Parnell**, *Alaska*
Hosted by Puget Sound Energy

1:45pm – 5:00pm

Concurrent Sessions: Energy II, Agriculture, Market Access, Disaster Resilience, Coastal and Ocean Caucus
Coffee break hosted by ASET

Session I
1:45 pm - 5:15 pm

Co-Chairs:

Rep. George Eskridge,
Idaho

Paul Manson, President,
Sea Breeze Power Corp.

Energy II (Renewable and Distributive Generation)

K'enaatnu Board Room

Power Development in the North: Panel on Renewable Energy in the Arctic
Overview of renewable energy in Alaska

- **Chris Rose**, *Executive Director*, Renewable Energy in Alaska Project (REAP)

Solar energy developments: An overview of solar development in the north with an example of a remote telecommunications install in the Yukon.

- **Stephen Mooney**, *Director*, Cold Climate Innovation, Yukon Research Centre

Ocean energy developments

- **Doug Johnson**, Ocean Renewable Power Company

Geothermal Energy and Global Opportunities for Alaska

- **Gwen Holdmann**, *Director*, Alaska Center for Energy and Power, University of Alaska

Micro-grids: Implications and Challenges for Local Utilities

Dialogue moderated by **George Roe**, Research Professor, Alaska Center for Energy & Power. Featuring: **Meera Kohler**, *President and CEO*, Alaska Village Electric Cooperative, Inc; **Darron Scott**, *CEO and President*, Kodiak Electric Association; **Emanuel DaRosa**, *President*, Northwest Territories Power Corporation

The North country is replete with micro-grids, necessitated by the geographic isolation of its population centers and the significant challenges associated with implementing trans-regional electrical interties. Communities and industry can thrive – or not – depending on the reliability, quality, and affordability of their energy systems. Our discussion will include an orientation to the basic elements of micro-grids, their similarity to and differences from more conventional grid configurations, and the challenges and opportunities associated with their implementation.

Role of Energy Efficiency in Creating Energy Independence featuring **Andrew Pape-Salmon**, *P.Eng., MR, Senior Specialist* – Energy, RDH Building Engineering Ltd.

- The value proposition for energy efficiency
- Job creation and economic development benefits; Pacific Coast Collaborative (PCC) West Coast Action Plan on Jobs
- State/Provincial/Territorial policy options – fiscal; regulatory; gov't leadership; utility incentives; research and development
- Best practices in PNWER
- Benefits for shaving peak electrical load (e.g., equipment standards reduce peak load for electric water heating or lighting)

Legislative Panel on Policy Options

Dialogue moderated by **Rep. George Eskridge**, Idaho, panel moderator

Featuring: **Rep. Jeff Morris**, *Chair of Committee on Technology and Economic Development, Member of Committee of Environment*, Washington; **Sen. Curt McKenzie**, *Chair of Committee of State Affairs*, Idaho; **Doreen Eagles**, *MLA*, Saskatchewan; **Minister Currie Dixon**, *Minister of Economic Development and Minister of the Environment*, Yukon

- What are the key energy efficiency policy priorities in your jurisdiction?
- What are some examples of best practices on the ground?
- What are the benefits of energy efficiency for reducing peak electrical load, improving grid reliability, and reducing capital expenditures?
What are some overarching action items like regional research project?
- How to highlight the merits of energy efficiency for job creation and economic development?

Action Items and Discussion

Session II
1:45pm - 5:15pm

Co-Chairs:

James Kettel,
Saskatchewan Ministry
of Agriculture

Patrick Kole, VP of Legal
and Government Affairs,
Idaho Potato
Commission

Agriculture
Khatnu 2

Opening Remarks: **Hon. Lyle Stewart**, *Saskatchewan Minister of Agriculture and PNWER President.*

Regulatory Cooperation Council (RCC)

Progress report and discussion on last year's RCC Action Item initiatives: Crop Protection Products, Mutual Reliance on Food Testing Results, and Common Approaches to Food Safety.

- **Robert Carberry**, *Assistant Secretary for RCC, Privy Council Office Canada*

Discussion on PNWER's commitment to remain actively involved in the advancement of current RCC initiatives, as well as introduce new issues that would benefit from the RCC's cross-border work.

Country-of-Origin Labeling (COOL)

Cross-border implications of mandatory COOL requirements on meat products: perspectives from U.S. and Canadian Industry on COOL's impact and methods for moving forward in a constructive way on this issue. Panel format (opening comments by each panel member and then an open floor discussion).

- **Aaron Canart**, *Feeder Cattle Procurement, Agri Beef Co.*
- **Martin Rice**, *Executive Director, Canadian Pork Council*

Low Level Presence (LLP) of Genetically Modified Crops

Discussion on LLP of Genetically Modified (GM) crops in imports of grain, food and feed. GM issues are currently emerging in certain U.S. states. The discussion could focus on: Canada and the U.S.'s current approach to LLP internationally; International approach to LLP policy in key market countries and what these countries are doing on LLP.

- **Lisa Zannoni**, *Syngenta Global Head, Regulatory and Stewardship, Seeds*
- **Luis Barnola**, *Senior Trade Policy Analyst, LLP Specialist, Agriculture and Agri-Food Canada*

Trans Pacific Partnership (TPP)

A discussion on Sanitary and Phytosanitary issues in relation to the TPP. Specifically, the U.S.'s proposed chapter in the agreement's text for an enforceable dispute settlement mechanism for TPP members; and/or intellectual property with respect to Geographical Indicators. This appeared in the Canada-European Union (EU) trade negotiations and will also appear in the U.S.-EU negotiations. The session could include a discussion on how Canada and the U.S. can find consistency on this issue in trade agreements.

- **Hon. Rob Merrifield**, *MLA, Yellowhead, Alberta*
- **Dr. Chris Sands**, *Senior Fellow, Hudson Institute*

Canada-U.S. Wheat

A discussion by representatives of the Canada-U.S. Grain and Seed Trade Task Group on their efforts to address regulatory differences impacting cross-border trade

- **William Hill**, *Flax Council of Canada*
- **Gary Martin**, *North American Export Grain Association*

Action Items - The group will prepare and commit to support a series of action items in relation to the topics discussed.

Session III
1:45pm - 5:15pm

Co-Chairs:

Donna Kennedy-Glans,
MLA, Alberta

Scott Rudderham,
Senior Vice President -
Operations, Canpotex,
Saskatchewan

Market Access *Tubughnenq 3*

All jurisdictions face an evolving and ever-changing challenges pertaining to market access. The dynamics of market access change as industries emerge and competition increases. Compounding this is the changes in technology, public opinion, shifting economic fortunes of countries, and both public and private enterprises. The market access session aims to initiate a discussion on market access issues across the region. Through a series of discussions that will occur over the course of the afternoon we will seek to identify the challenges that each jurisdiction in the PNWER region faces and how the challenges should be addressed. The session will provide opportunities for a dialogue with all member jurisdictions, first through thought provoking presentations on a variety of specific market access topics, and then a moderated panel discussion.

Potash and Pulses

Market access for potash, pulses and other agriculture products is crucial in many jurisdictions. There exists opportunities for expansion in sales of these products abroad.

- **Lionel LaBelle**, *President and Chief Executive Officer*, Saskatchewan Trade and Export Partnership

Coal and Electricity Transmission

Demand for these energy commodities now spans the globe and the need for a more robust domestic infrastructure and export capacity is necessary to their continued development.

- **Tom Kaiserski**, *Program Manager*, Montana Department of Commerce, Energy Promotion and Development Division

Oil and Natural Gas

Market access issues exist as they relate to the transportation of energy products. As production increases, market access constraints will shape the markets that these products are able to access.

- **Michael Holden**, *Senior Economist*, Canada West Foundation

Transportation and Tidewater Access

Ports on the west coast face challenges and change in how they do business. As gateways in and out of the continent they face growing challenges to balance the interests of those who use their ports with the interests of those who live near port areas or who live in areas en route to ports.

- **Jim Belsheim**, *President*, Neptune Bulk Terminals, North Vancouver, B.C.

Action items

Session IV
1:45pm - 5:15pm

Co-Chairs:

Rep. Deb Boone,
Oregon

Eric Holdeman, Direc-
tor, Center for Region-
al Disaster Resilience

Disaster Resilience *Tubughnenq 4*

Arctic Oil Spill Response Round Table – Participants will discuss current efforts to plan for the worst and identify new areas of collaboration to help the region become more prepared for an event in the arctic. Moderated by **Nils Andreassen**, *Institute of the North*

- **Mayor Reggie Joule**, *Northwest Arctic Borough*
- **Bob Heavilin**, *General Manager/CEO*, Chadux
- **Gary Folley**, *Program Manager*, Alaska Department of Environmental Conservation
- **Christy Bohl**, *Bureau of Safety and Environmental Enforcement (BSEE) Dept of the Interior*
- **Commander Shane Montoya**, *Deputy Sector Commander*, U.S. Coast Guard

<p>Session IV</p> <p>Continued - Disaster Resilience</p>	<p>Utilizing Social Media to Enhance Regional Disaster Resilience Emergency management and first responders are beginning to embrace social media in new ways to assist in providing real-time updates during events and emergencies. This new way of thinking has led to the development of an innovative system in our region. The “First-to-See” social media system that is being developed in the Puget Sound for citizen reporting suspicious activity and damages (plus specialized backend software for agencies to use to manage social media during an incident) will be demonstrated and discussed.</p> <ul style="list-style-type: none"> • Eric Holdeman, <i>Director</i>, PNWER Center for Regional Disaster Resilience <p>Oregon Resilience Plan Oregon is taking a leading effort to develop an innovative resiliency plan to prepare for a major event such as a 9.0 subduction zone earthquake. This effort has been ongoing for over a year and has involved hundreds of public and private stakeholders. Learn how this effort was initiated at the grassroots level and endorsed by the legislature. Also, learn how other states and provinces can benefit from this experience.</p> <ul style="list-style-type: none"> • Jay Raskin, <i>AIA</i>, Ecola Architects, PC (via teleconference) • Rep. Deb Boone, Oregon <p>Action Items</p>
<p>Session V 1:45pm - 5:15pm</p> <p>Co-Chairs: Sen. Kevin Ranker, Washington</p> <p>Molly McCammon, Executive Director, Alaska Ocean Observing System</p>	<p>Ocean and Coastal Caucus <i>Tubughnenq 5</i></p> <p>Ocean Acidification</p> <ul style="list-style-type: none"> • Background on ocean acidification • Shellfish and fishery issues <ul style="list-style-type: none"> • Bill Dewey, <i>Public Affairs/Shellfish Farmer</i>, Taylor Shellfish Farms <p>Panel discussion including above speakers and Senator Arnie Roblan, Oregon</p> <ul style="list-style-type: none"> • Coordinated strategies • Funding options and opportunities <p>Arctic Issues</p> <ul style="list-style-type: none"> • Implications of an ice-free arctic on global shipping <ul style="list-style-type: none"> • Andrew Metzger, <i>Assistant Professor</i>, University of Alaska, Fairbanks • The effects of Arctic ocean policies on the non-Arctic states <ul style="list-style-type: none"> • Stefanie Moreland, <i>Special assistant to Governor Parnell</i>, State of Alaska • Integrated Arctic Management Plan: Model or not? <ul style="list-style-type: none"> • Pat Pourchot, <i>Special Assistant for Alaska Affairs</i>, Secretary of the Interior • Presenter’s Q&A and discussion of action items <p>National Issues</p> <ul style="list-style-type: none"> • Update on National Ocean Policy Implementation <ul style="list-style-type: none"> • Deerin Babb-Brott, <i>Director</i>, National Ocean Council • Presenter’s Q&A
<p>5:15pm - 5:45pm</p>	<p>Arctic Caucus Brief-Out (All Co-chairs invited) <i>Tikahtnu D, Third Floor</i></p>
<p>6:00pm - 7:30pm</p>	<p>Light Reception and Fur Fashion Show - <i>Marriott Ballroom</i> Hosted by Carlile Transportation Systems</p>
<p>7:30pm</p>	<p>Free Evening - Dinner on your own</p>
<p>8:30pm - 11:00pm</p>	<p>Hospitality Suite - <i>Hotel Captain Cook, Club Room #1, 10th floor, Tower 1</i> Hosted by The Government of Yukon</p>

WEDNESDAY, JULY 17 *All sessions held in the Dena'ina Convention Center*

7:00am - 5:00pm

Registration - Dena'ina Convention Center, third floor

7:30am - 9:00am

Keynote Breakfast

Tikahtnu Ballroom BC

Featuring **Dr. David Lodge**, University of Notre Dame, "Budget-busting Invasive Species from Kudzu to Quagga to Apple Maggot to Carp" presented by the Invasive Species Working Group

Hosted by HDR

9:15am - 11:45am

Concurrent Sessions: Mining, Cross-Border Livestock Health Conference, Invasive Species Conference, Coastal & Ocean Caucus, "The Inside Passage": A three-part track combining Border, Transportation & Tourism Working Groups

Coffee break hosted by Princess Cruises

Session I

9:15am - 11:45am

Mining

K'enakatnu Board Room

Co-Chairs:

Sen. John Coghill, Alaska

Pam Schwann, Executive Director, Saskatchewan Mining Association

Mineral overview of PNWER region

- Presentation on the mineral resources of the 10 PNWER jurisdictions, including strategic minerals
 - **Pam Schwann**, Executive Director, Saskatchewan Mining Association
 - **Sen. John Coghill**, Alaska

Innovative Mining Practices in light of Climate Change - Panel discussion on how mining companies and projects are being affected by a changing climate, what the adaptations are being used now, and what may be needed in the future.

- **Cam McNaughton** PhD., P.Eng, *Environmental Engineer*, Golder Associates Ltd.

"Mining and Sustainable Communities"

- **Bob Loeffler**; *Visting Professor of Public Policy*, University of Alaska at Anchorage
- **Gary White**, P. Geo., *Executive Director*, Coal and Mineral Development, Alberta Energy Mining Supply Chain Management

Discussion on the complexities and challenges of the mining supply chain, including discussion of logistics; procurement and economic development across PNWER jurisdictions; and risk management of major capital projects.

- **John Heskin**, KPMG, British Columbia
- **Deantha Crockett**, *Executive Director*, Alaska Miners Association

Action items

Session II

9:15am - 11:45am

Cross-Border Livestock Health Conference

Kahtnu 2

Co-Chairs:

Dr. Robert Gerlach, Alaska State Veterinarian

Mr. Mike Nikolaisen, British Columbia Association of Cattle Feeders

Antimicrobial Resistance and Livestock Production

- **Dr. Trevor Alexander**, Agriculture and Agri-Food Canada

Public Risk vs. Public Perception regarding Antimicrobial use in Agriculture

- **Dr. Reynold Bergen**, Canadian Cattlemen's Association

Trade and industry issues with the use of B-adrenergic agonists in livestock

- **Del Holzer**, Elanco

Session II
Continued - Cross-border
Livestock Health Confer-
ence

Panel Discussion with Speakers

- Moderated by **Dr. Betty Althouse**, *Saskatchewan Chief Veterinary Officer*

Update and Discussion on Previous Action Items - Co-Chairs

Session III
9:15am - 11:45am

Transportation, Tourism and Border Joint Session: Part I

Tubughnenq 4

Co-Chairs:

Co-chairs provide an overview of PNWER's Transportation Working Group: The Legislative Primer and Vancouver/Prince Rupert B.C. pre-conference tour.

Senator Curt McKenzie,
Idaho

Alaska Transportation 101: An overview of the unique system in the state (air, road, rail, marine and pipeline) and information on the Alaska Port Study.

Bruce Agnew, Director of
the Cascadia Institute

- **Steve Hatter**, *Deputy Commissioner of Aviation* for the Alaska Department of Transportation and Public Facilities (DOT&PF).

Idaho's role as inland "crossroads" to provide a broader PNWER member perspective. A private-sector view of Alaska transportation challenges, including intermodal operations.

- **Brian Ness**, *Director*, Idaho Department of Transportation Director

Panel featuring transportation experts and legislators on both sides of the border

- **John MacKinnon**, *Executive Director*, Association of General Contractors Alaska
- **Linda Leary**, *President*, Carlile Transportation Systems
- **Rep. Peggy Wilson**, Alaska
- **Rick Boyles**, *Secretary-Treasurer*, Teamsters Local 959

Action Items

Session IV
9:15am - 11:45am
Lunch in session,
session continued in after-
noon

Invasive Species Conference

Tubughnenq 3

Co-Chairs:

Update from PNWER jurisdictions: The greatest successes, the largest threats

Rep. Eric Anderson, Idaho

- Alaska
- Idaho
- Oregon
- Montana
- Washington
- Alberta
- British Columbia
- The Northwest Territories
- Saskatchewan
- Yukon

Dr. Mark Sytsma, Asso-
ciate Vice President for
Research, Portland State
University

Alaska and Northern Pike Eradication: A success story

- **Kristine Dunker**, Alaska Department of Fish and Game, Sport Fish Division

Topic Focus: Invasive Weeds

- Weed Challenges in Alaska
- **Brianne Blackburn**, Alaska Department of Natural Resources

Session IV
Continued - Invasive
Species Conference

Challenges and Successes in Information Sharing

- **Matt Carlson**, *Assistant Professor & Program Botanist*, University of Alaska Anchorage

Challenges of Northern, and Oil and Gas Development

Networking luncheon: “Invasives in the North” featuring **Tammy Davis**, *Invasive Species Program Lead*, Alaska Department of Fish and Game

Session V
9:15am - 11:45am

Co-Chairs:

Sen. Kevin Ranker,
Washington

Molly McCammon, Ex-
ecutive Director, Alaska
Ocean Observing System

Ocean and Coastal Caucus II
Tubughnenq 5

Marine Debris

- Tsunami Debris and Federal Policy
- **U.S. Congresswoman Suzanne Bonamici**, Oregon (via teleconference)

Overview of marine debris

- **Peter Murphy**, *Alaska Regional Coordinator*, NOAA Marine Debris Program

Tsunami Debris Task Force

- **Kim Lippert**, *Public Information Officer*, Oregon Emergency Management (Via teleconference)
- **Laura Leebrick**, *Governmental Affairs Director*, Oregon Refuse & Recyclers Association (via teleconference)

Economic and environmental impacts of shipping containers

- **Chris Pallister**, *Co-Founder*, Gulf of Alaska Keeper

Resilience and Tsunami Debris

- **Vicki McConnell**, *Oregon State Geologist*, Oregon Department of Geology and Mineral Industries (DOGAMI) (Via teleconference)

Presenters Q&A and discussion of action items

12:00 pm - 2:00 pm

Keynote Luncheon
Tikahtnu Ballroom BC, Dena’ina Conference Center, third floor
Featuring **Consul General Denis Stevens**, *Consul General of Canada in Seattle* and **Consul General Anne Callaghan**, *U.S. Consul General in Vancouver*. Moderated by **Chris Sands**, *Senior Fellow*, Hudson Institute

Hosted by Nelson Mullins

2:15pm - 5:00 pm

Concurrent Sessions: Natural Gas as a Transportation Fuel, Cross-Border Livestock Health Conference, Invasive Species Conference, Workforce and “The Inside Passage”: A three-part track combining Border, Transportation & Tourism Working Groups

Coffee break hosted by NWGA

Session I
2:15pm - 5:00pm

Co-Chairs:

Senator Fred Dyson,
Alaska

Ian Burkheimer, Trans
Energy Solutions

Natural Gas Transportation
K’enakatnu Board Room

Overview of growing Natural Gas market and LNG 101

- **Ian Burkheimer**, *Director of Marketing and Sales*, TransEnergy Solutions

Natural Gas Remote Applications and Virtual Pipelines, other areas of transportation use (rail and maritime), and International Projects

- **Kirt Montague**, *CEO*, Plum Energy

A look at remote Natural Gas applications in Alaska and the Fairbank natural gas project

- **Dan Britton**, *President and CEO*, Fairbanks Natural Gas

Session I
Continued - Natural Gas
Transportation

A look at remote Natural Gas applications in Alaska and the Fairbank natural gas project

- **Dan Britton**, *President and CEO*, Fairbanks Natural Gas

How Rubber Hits the Road: An Update on FortisBC's Natural Gas for Transportation Program, and an update on the regulatory environment in British Columbia

- **Samantha Collins**, *Government Relations & Public Affairs Manager*, FortisBC

Discussion and development of Action Items

Session II
2:15 pm - 5:00 pm

Cross-Border Livestock Health Conference

Kahtnu 2

Co-Chairs:

Food costs and the consumer with increasing animal welfare pressures

- **David Fikes**, *Food Marketing Institute*

Dr. Robert Gerlach, *Alaska State Veterinarian*

Animal welfare pressures on meat processors in USA/Canada

- **Dr. Lily Edwards-Callaway**, *JBS USA*

Mike Nikolaisen, *British Columbia Association of Cattle Feeders*

Panel Discussion with Speakers, Moderated by **Franci Havemeister**, *Alaska Director of Agriculture*

Regulatory Cooperation Council (RCC) Progress Updates

- **Robert Carberry**, *Assistant Secretary for RCC, Privy Council Office Canada*

Session III
2:15pm - 5:00pm

Transportation, Tourism and Border Joint Session: Part II

Aboriginal Tourism and Crossing Borders

Tubughnenq 4

Co-Chairs:

This session will explore the growth and potential of aboriginal tourism in our shared region, as well as the importance of creating a quality experience for travelers who cross borders.

Participants will help bring the operator and traveler's perspective together to explore ways to facilitate cross-border tourism. Picking up on 2012 action items, session outcomes will focus on where regulatory support, research and bilateral discussion are needed to grow cross-border tourism in the PNWER region. *How can we collaboratively create seamless tourism opportunities that benefit all our coastal and inland communities? Are there unique land, sea and air transportation or regulatory barriers that are limiting our potential for PNWER members to become a tourism "super region"?*

Rep. Lindsey Holmes, *Alaska*

Dave Cowen, *General Manager, Butchart Gardens*

Introduction - Cooperation with Brand USA and potential for two-nation vacation

- **Michelle McKenzie**, *President & CEO, Canadian Tourism Commission*

Aboriginal Perspective

Cross-border perspectives on developing a cultural and aboriginal tourism market

- **Rep. Lindsey Holmes**, *Alaska*
- **Annette Evans Smith**, *President and CEO, Alaska Native Heritage Center*
- **Keith Henry**, *CEO, Aboriginal Tourism BC*

Transportation perspective

British Columbia perspective on tourism and efficiently moving travelers across borders featuring

- **Dave Cowen**, *General Manager, Butchart Gardens*
- **Andrew Little**, *Manager, Intergovernmental Relations and Planning, Tourism (British Columbia)*

Session III
Continued - Aboriginal
Tourism and Crossing
Borders

Alaskan cruise industry. Brief history on what we've learned in the past few years. Challenges in the future which will impact if we continue to grow, stay static or decline

- **John Binkley**, *President*, Alaska Cruise Association

Cross-border transportation perspective between BC, Seattle, Bellingham

- **Sheldon Eggen**, *President and CEO* of Charter Bus Lines of BC and co-owner of Quick Coach Lines Inc.
- **Barry Keys**, *co-owner and president* of Quick Coach Lines

Alaska cruise opportunities and challenges relevant to two-nation vacations, border, environment. Emerging source markets and transportation connectivity.

- **Curtis Grad**, *President and CEO*, Greater Victoria Harbour Authority

Facilitated discussion led by **Dave Cowen** and **Andrew Little** in addition to formation of action items.

How can we better understand each other to align our efforts in tourism in the region?

Session IV
2:15pm - 5:00pm

Co-Chairs:

Dr. Mark Sytsma, Portland State University

Rep. Eric Anderson, Idaho

Invasive Species Conference

Tubughnenq 3

Expert Panel on Invasive Species and the Border

The international border poses a challenge in controlling invasive species; differing policy in regulations, inspection, and understanding of invasive species threats can leave jurisdictions in both countries at risk. This panel will address obstacles to stopping invasive species at the border, protocol challenges and regional successes and opportunities.

- **Kara Cornum**, *Agriculture / Training Supervisor*, U.S. Customs and Border Patrol
- **Lloyd Knight**, *Administrator*, Idaho Department of Agriculture

Quagga and Zebra Mussels: An Update on Regional Efforts

Outcomes of the May 15th meeting, "Preventing an Invasion: Building a Regional Defense against Quagga and Zebra Mussels"

- **Mark Sytsma**, *Associate Vice President for Research*, Portland State University
- **Stephen Phillips**, *Program Manager*, PSMFC

The future of Federal Activities Panel Discussion: Legislative challenges in Invasive Species Control

Invasive species don't recognize state or federal borders, which can make legislation at the local level a challenge. This panel will explore recent legislation on quagga and zebra mussels, and other triumphs in invasive species legislation, and discuss the opportunities for regional collaboration, to create a perimeter of protection for the region.

- **Rep. Eric Anderson**, Idaho
- **Rep. Deb Boone**, Oregon
- **Rep. Mike Cuffe**, Montana
- **Rep. Bruce Chandler**, Washington
- **Hon. Cal Dallas**, *Minister of International and Intergovernmental Relations*, Alberta
- **Hon. Currie Dixon**, *Minister of the Environment*, Yukon
- **Rep. Peggy Wilson**, Alaska

Tsunami Debris: The Environmental and Invasive Species Challenges

- **Jesse Schultz**, *Environmental Specialist 4*, Washington Department of Fish and Wildlife
- **Peter Murphy**, *Alaska Regional Coordinator*, NOAA Marine Debris Program

Summary and Discussion; Status of Action Plan

Next Steps and Action Items

Session V
2:15pm - 5:00pm

Co-Chairs:

Colin Smith, Association of Professional Engineers and Geoscientists, British Columbia (APEGBC)

Sen. Cathy Giessel, Alaska

Workforce
Tikahtnu D, Third Floor

Inspiring Economic Development: Showcasing Native American and First Nation training opportunities in the North

- **Florian Borowski**, *Regional Human Resources Director, CH2M Hill*
- **Kristina Patrick**, *Senior Director of Shareholder Development, NANA*

Mobility for the Pacific Northwest’s World Class Skilled Workforce: Encouraging workforce mobility in high-demand sectors

- **Mike Wo**, *Former Executive Director, Edmonton Economic Development Corporation*

Advancing regional collaboration: Reciprocal engineer licensing agreements in the Pacific

Session VI
2:15PM - 5:00PM

Co-Chairs:

Sen. Kevin Ranker, Washington

Molly McCammon, Executive Director, Alaska Ocean Observing System

Ocean and Coastal Caucus III
Tubughnenq 5

Ocean Energy

Overview of Ocean Energy

- **Sean Skaling**, *Deputy Director, Alternative Energy and Energy Efficiency*

Tidal Energy

- **Monty Worthington**, *Project Development Director, Ocean Renewable Power Company, Alaska LLC*
- **Craig Collar**, *Assistant General Manager, Power, Rates, and Transmission Management, Snohomish County PUD*
- **Andrew Walls**, *Director, Customer Development and Marketing, New Energy Corporation*

Oregon Territorial Sea Plan Amendment

- **Patty Snow**, *Program Manager, Oregon Coastal Management Program*

Presenters Q & A and Discussion of Action Items

Marine Commerce and Trade

- **Nils Andreassen**, *Managing Director, Institute of the North*
- **Brett Farrell**, *Deputy Director, Alaska Marine Exchange*
- **Brit Szymoniak**, *Director of Public Affairs and Business Development, Port of Anchorage*

Presenters Q&A and discussion of Action Items

5:15pm - 5:45pm

Arctic Caucus Brief-Out (All Co-chairs invited)
Tikahtnu D, Third Floor

6:30pm - 9:00pm

Reception
Featuring **Mayor Dan Sullivan**, City of Anchorage - *Alaska Native Heritage Center*.
Buses depart from the Marriott Hotel at 6:30pm

Hosted by Enbridge

9:00pm

Hospitality Suite - Marriott Ballroom

Hosted by APEGA, APEGS, APEGBC

7:00am - 10:00am

Registration - Dena'ina Convention Center, third floor

7:30am - 9:00am

Keynote Breakfast

Tikahtnu Ballroom BC

Alaska Arctic Policy Commission Panel featuring **Sen. Lesil McGuire**, and **Rep. Bob Herron**, *Co-Chairs* of the commission, **Stephen Trimble**, URS Corp, and **Pat Pourchot**, U.S. Department of the Interior

Hosted by ConcoPhillips

9:15am - 11:45am

Concurrent Sessions: Energy Storage, Cross-Border Livestock Health, and Trade and Economic Development

Coffee break hosted by TransCanada

Session I

9:15am - 11:45am

Energy Storage

K'enakatnu Board Room

Co-Chairs:
Rep. Jeff Morris,
Washington

State of the Energy Storage industry in the PNWER region

Energy storage in remote village applications: How is technology transforming the ability of remote communities to produce stable power at an affordable price?

- **Rick Winter**, *COO*, UniEnergy Technologies
- **Tom Noelle**, *Vice President*, Business Development, Xtreme Power

Gwenn Holdmann, Alaska Center for Energy and Power

Action items and discussion

Session II

9:15am - 11:45am

Cross-Border Livestock Health

Kahtnu 2

Co-Chairs:
Dr. Robert Gerlach,
Alaska State Veterinarian

One Health -- Implications for Cross-Border Trade

- **Bob Harding**, Canadian Swine Health Board

Mike Nikolaisen, British Columbia Association of Cattle Feeders

Humans, livestock, and wildlife interfaces in Alaska

- **Dr. James Berner**, Alaska Native Medical Center

Panel Discussion with speakers

- Moderated by **Dr. Mary Vanderkop**, *Chief Veterinary Officer*, Yukon

Action items and discussion

Session IV

9:15am - 11:45am

Trade and Economic Development: Opportunities and Challenges of Northern Economic Development

Tubughnenq 4

Co-Chairs:
Hon. David Ramsay,
Minister of Industry,
Tourism, and Investment,
Northwest Territories

Overview of Arctic development in the Northwest Territories, and the importance of the Arctic to the rest of PNWER

- **Hon. David Ramsay**, Minister of Industry, Tourism, and Investment, Northwest Territories

Carl Portman, Deputy Director, Alaska Resource Development Council

An overview of key challenges of resource development in Alaska

- **Carl Portman**, Deputy Director, Alaska Resource Development Council

Detailed Agenda

Session IV
Continued - Trade and
Economic Development

Alaska Resource Extraction study: This study looks at an overview of the next 10 years of oil and gas, mining, energy/power, and other projects, including Arctic OCS development projects most likely to forward

- **Bill Popp**, *President and CEO*, Anchorage Economic Development Corporation

Development perspectives from Alaska: an overview of Alaska's economic development opportunities and challenges with a focus on the State's priorities

- **Susan Bell**, *Alaska Commissioner* of the Department of Commerce, Community and Economic Development

North American Arctic Economic Development Trends

- **John Higginbotham**, *Senior Fellow*, Carleton University and Centre for International Governance Innovation

Discussion and Development of Action Plan

Discussion of opportunities for regional representation in Arctic Business Council.

Facilitated by **Minister Ramsay** and **Carl Portman**.

- *Are North American business views being effectively heard in terms of Arctic policy?*
- *As Canada develops the terms of reference for an Arctic Business Council what principles might we suggest to make an effective representative and sustainable structure?*
- *What does North American business community need from governments to develop opportunities in the Arctic?*
- *What policies could stimulate greater infrastructure development in the Arctic?*

Discussion of Partnerships for State/Provincial International Trade Offices

- **Rep. Gael Tarleton**, *Washington*

12:00pm - 2:00pm

Keynote Luncheon

Tikahtnu Ballroom B and C, Dena'ina Center, third floor

Featuring **The Honourable Bob McLeod**, *Premier of the Northwest Territories*; **Lt. Governor Mead Treadwell**, *Alaska* and **Patrick Borbey**, *President*, Canadian Northern Economic Development Agency and Chair of the Arctic Council's Senior Arctic Officials (SAO).

Hosted by CropLife Canada and CBI Canada

2:30pm - 5:00pm

Executive Committee Meeting - Open to all participants

K'enakatnu Board Room

Session I
2:30pm - 5:00pm

Cross-Border Livestock Health Conference

Kahtnu 2

USDA Updates on E-Certification

- **Dr. Cynthia Gaborick**, *U.S. Department of Agriculture*

Co-Chairs:

Dr. Robert Gerlach,
Alaska State Veterinarian

Western States E-Certification Progress

- **Dr. William Brown**, *Kansas Animal Health Commissioner*

Mr. Mike Nikolaisen,
*British Columbia
Association of Cattle
Feeders*

E-Certification technology advancements – iPad App demonstration

- **Dr. Keith Biggers**, *Texas A&M University*

Panel Discussion with speakers on E-Certification Progress moderated by **Aaron Canart**, *Agri Beef Co.*

FRIDAY, JULY 19

All Day

All Day Policy Tour Options

Tours include day-long Nome Gold Rush Tour to Nome, Alaska where visitors will see native corporations, meet with the local business community, see the Port of Nome, gold dredges and more. The other tour option is the Pebble Mine Tour. Pre-registration required.



Above: PNWER delegates visit Eagle Point Uranium Mine in northern Saskatchewan during the 2012 Annual Summit



Left: Round table participants engaging with PNWER's federal partners from Canada and the United States. Two U.S. senators from Alaska, Sen. Lisa Murkowski (left) as well as Sen. Mark Begich, joined round table participants at the PNWER event in March, 2013 in Washington, D.C.

PNWER is excited to offer a number of exciting policy tours during the 2013 Annual Summit in Anchorage, Alaska. Advanced registration is required, but space may still be available. Please check with the registration desk for availability and purchasing information.

Cross-border Security and Economic Development Pre-Summit Tour

July 11-14 | 25 participants



This multi-day tour is hosted by the Consulate General of Canada Seattle, Cascadia Center for Regional Development, and the Pacific Northwest Economic Region.

State legislators, port officials, union representatives, and business leaders will explore multiple aspects of bi-national trade and security issues. The tour begins at the Peace Arch and Pacific Highway crossings, followed by tours of Port Metro Vancouver and presentations on the Asia Pacific Gateway and Corridors Initiative. In Prince Rupert, B.C., the Canadian Coast Guard, Prince Rupert Port Authority, and private sector businesses will host the group. Before arriving in Anchorage, participants will visit Ketchikan, Alaska to enjoy the hospitality of the Chamber of Commerce and local businesses. Please look forward to a legislative primer detailing our transportation and security findings to be released following the tour.

26 Glaciers Cruise

Monday, July 15 | Cost: \$100 | Pre-registration required



A journey into Prince William Sound is unforgettable. The 26 Glacier Cruise travels 145-miles in 5-hours to explore the serenity of Esther Passage, view

majestic alpine and tidewater glaciers in College and Harriman Fjord while allowing guests to travel in luxurious comfort aboard the Klondike Express, the fastest catamaran in Alaska. The 26 Glacier Cruise includes a complimentary hot lunch, narration provided by a U.S. Forest Service Ranger, assigned indoor seating, full-service bar and snacks available for purchase, restroom equipped, and a no seasickness guarantee.

Northern Economic Development Pre-Summit Tour

Thursday, July 11 - Sunday, July 14 | Cost: \$500 | Limit: 15
Pre-registration required



Enjoy a multi-day trip exploring various energy production sites while viewing the beauty of Fairbanks, Healy and Denali National Park. This exciting

pre-summit tour begins in Fairbanks on July 12th and will feature visits to the Flint Hills Refinery, BESS (Battery Energy Storage System), Alaska Center for Energy and Power, Fort Knox Gold Mine, and Eva Creek Wind Project before the group stops in Healy, Alaska for the night. The next day will include tours of the Healy Clean Coal Project and Usibeli Coal Mine before ending in beautiful Denali National Park. On Sunday, participants will enjoy a visit to the Denali Education Center to learn more about the local wildlife.

Ted Stevens Anchorage International Airport

Thursday, July 18, 9:00 - 12:00pm | Cost: \$25 | Limit: 40



In Anchorage, 1 in 10 jobs in the community are directly related to the Airport. Tour the airfield and airport, learning about the history, service, and future

of the facility. Please wear walking shoes for this in-depth look behind the scenes!

PNWER is excited to offer a number of exciting policy tours during the 2013 Annual Summit in Anchorage, Alaska. Advanced registration is required, but space may still be available. Please check with the registration desk for availability and purchasing information.

WJ Hernandez Hatchery Tour

Thursday, July 18, 9:15 - 12:00pm | Hosted by HDR | Limit: 25



The new William Jack Hernandez Sport Fish Hatchery is successfully serving the dual purpose of promoting sustainable fisheries and enhancing the Alaska economy by using innovative

engineering design. The 141,000-square-foot hatchery is the largest facility owned and operated by the Alaska Department of Fish & Game, Division of Sport Fish (DSF). With a mission to protect and improve the state's recreational resources, DSF operates hatcheries throughout Alaska. At full capacity, the new facility will produce 6 million fish, including Chinook and Coho salmon, rainbow trout, lake trout, Arctic char, and Arctic grayling. The hatchery will be an important contributor to sport fishing in Alaska, which nets the state economy \$1.4 billion annually. It has been awarded a 2013 Outstanding Civil Engineering Achievement Award by ASCE, a 2012 National Recognition Award from ACEC, and will receive the first ever ISI Envision Sustainability certification in July, 2013. The tour will cover hatchery operation and site and describe the policy framework that guides Alaska's sport fish stocking programs.

NORAD Tour

Thursday, July 18, 2:00 - 5:00pm | Cost: \$525 | Limit: 25

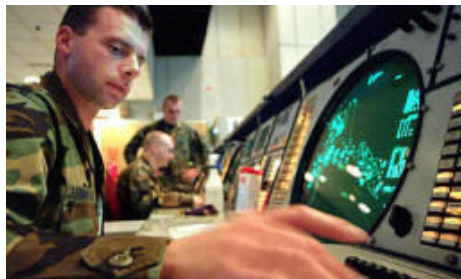

This tour features a trip to the Alaska North American Aerospace Defense Command (NORAD) Region, located at the Elmendorf Air Force Base in Anchorage. Alaska

NORAD Region is a combined U.S. and Canadian organization in charge of monitoring and controlling aerospace for North America. The visit will include a presentation about the function and responsibilities of Alaska NORAD, and visits to the Uklua Memorial, the Bald Eagle Aviary and Air Park.

Nome Gold Rush Tour

Friday, July 18 | Cost: \$400 | Limit: 15
Pre-registration required



Enjoy an all day trip to Nome, Alaska! The City of Nome (pop. 3,700) is located the Arctic Circle, the city serves as the commercial and transportation hub for many villages in the Bering

Strait region. The tour will visit the Kawerak, Inc., Sitsnasuak, Bering Strait and Norton Sound Economic native corporations. Mayor Michels will guide participants through the Port of Nome followed by a visit to the gold dredges.

Pebble Mine Tour

Friday, July 18 | Cost: \$400 | Limit: 15



Pebble Mine is the mineral exploration project investigating a very large porphyry copper, gold, and molybdenum mineral deposit in the Bristol Bay region of Southwest Alaska. The tour

includes a helicopter to the Pebble deposit area and drill site, as well as a tour of the core shack. Hosted by Pebble Limited Partnership.



Delegates from the 2007 PNWER Summit in Anchorage enjoy the 26 Glaciers Cruise, the same voyage 2013 delegates will enjoy at the 23rd Annual Summit this summer.

Improving quality of life; WITH FAR-REACHING ECONOMIC BENEFITS

ConocoPhillips is the world's largest independent exploration and production company, based on proved reserves and production of liquids and natural gas. We explore for, develop, and produce crude oil and natural gas globally. A commitment to safety, operating excellence and environmental stewardship guide our operations in 30 countries.

Our portfolio includes legacy assets in North America, Europe, Asia and Australia; growing North American shale and oil sands businesses; a number of major international development projects; and a global exploration program.

We are active in a wide range of geologic and geographic settings, including some of the world's most challenging areas. From the arid desert to the frozen Arctic, we have a proven track record of responsibly and efficiently finding and producing oil and natural gas.

Alaska and Canada: An Arctic Offshore Snapshot

ConocoPhillips Canada and Alaska operations combined represent over 100 years of arctic oil and gas exploration and development experience.

ConocoPhillips is one of the largest oil and natural gas exploration and production companies in Canada, with a world-class portfolio that includes assets in Western Canada, the Arctic and the oil sands near Fort McMurray, Alberta.

ConocoPhillips has been one of the principal players in the Canadian Mackenzie River Delta and Beaufort Sea areas since the late 1960s, and operates both the Parsons Lake and Amauligak discoveries.

In the Canadian Arctic offshore, front-end engineering analysis to assess development options is underway for the Amauligak discovery, the largest oil and gas field in the Mackenzie Delta and Beaufort Sea areas.

ConocoPhillips is also pursuing opportunities offshore Alaska, having been awarded 98 exploration lease tracts in the Chukchi

Sea Outer Continental Shelf in 2008. ConocoPhillips recently put its 2014 Alaska Chukchi Sea exploration drilling plans on hold, due to the uncertainties of evolving federal regulatory requirements and operational permitting standards.

Alaskan Opportunities Onshore

ConocoPhillips is Alaska's largest oil producer and one of the largest owners of state and federal exploration leases in Alaska.

In addition to its natural gas-focused assets in Cook Inlet, ConocoPhillips has major ownership interests in two of North America's largest oil fields, both located on Alaska's North Slope – Kuparuk, which the company operates, and Prudhoe Bay. Additionally, ConocoPhillips has a significant operating interest in the Alpine Field, located on the Western North Slope.

While the larger North Slope fields have been in production for decades, significant development opportunities still exist. With the recent state severance tax change improving Alaska's business climate, ConocoPhillips has already added a rig at its Kuparuk Field. The company also plans to work with co-owners to fund a new drill site on the southwest flank of the Kuparuk River Field, and it is entering the regulatory/permitting activities phase and progressing the engineering for the Greater Moose's Tooth Unit in the National Petroleum Reserve-Alaska (NPR-A).

In the fourth quarter of 2012, Alaska's Alpine West CD5 project was approved. Construction is scheduled to begin in the winter of 2014. Representing the first commercial production from the National Petroleum Reserve – Alaska, first oil from CD-5 is expected to flow in late 2015.

The ConocoPhillips Journey

Producing oil and natural gas and getting them to market takes ingenuity, technology and investment. Our innovative, collaborative efforts yield products that improve quality of life globally while producing economic benefits with far-reaching influence.

In 2012, ConocoPhillips made real progress in unlocking our full potential as an independent company. We recognize that the journey continues and look forward to further progress in the future.

This article is a submission by, and reflects the views of, 2013 Annual Summit Sponsor ConocoPhillips. The Pacific NorthWest Economic Region is not responsible for the content of this piece.



The New Frontier

Given the fragile Arctic ecosystem and the indigenous people who rely on it for their subsistence, the Northern Sea Route desperately needs a management system for both vessel safety and environmental protection, sooner as opposed to later.

Alaska has long been known as the Last Frontier with the Arctic Region being its remotest portion. Alaska's Arctic coastline is now becoming USA's Newest Frontier with the decreasing ice pack creating a viable Northern Sea Route that brings Asian and European markets 4000 miles closer. Arctic offshore oil and gas development and onshore mineral development bring their own set of support needs. Consequently, vessel traffic is increasing in the Arctic; however, vessels transiting the Northern Sea Route or supporting resource development currently do so without basic nearby port and landside infrastructure, a timely search and rescue response capability to vessels in distress, or an organized approach to remediating an environmental threat.

Given the fragile Arctic ecosystem and the indigenous people who rely on it for their subsistence, the Northern Sea Route desperately needs a management system for both vessel safety and environmental protection, sooner as opposed to later.

Developing a management system for the Northern Sea Route would address the protection of the environment and the safety of vessels plying the route. Seaways are managed



all over the world with many good examples including the Panama Canal, Suez Canal, and St. Lawrence Seaway, among others. The Arctic management system does have unique and multiple complex challenges, though, as compared to other seaways.

Basic services needed to support safe shipping lanes include vessel communications, search and rescue capabilities, tug response, vessel repair services, and a harbor of refuge, as a bare minimum. The basics each involve a set of challenges due to the Arctic's remote location and extreme climate, which may require the development of new or improved existing technologies, in addition to the challenge of developing and supporting multinational collaboration.

Technical challenges arise for vessel communication systems as GPS systems have reduced signal accuracy above 50 degrees North latitude. To avoid icebergs and other navigational hazards, a system of clearly communicating the hazards' location relative to the vessels is necessary.

Search and rescue efforts may likely require icebreaker capacity, of which the U.S. has three **[Continued on page 34]**

older vessels with limited capabilities.

Another challenge involves developing a tug service to assist vessels in distress. Defining acceptable response criteria, likely measured in days, will decide if the tugs should be based at multiple ports for a faster response or at one port offering vessel repair services, as well as determining if the economics are sufficient to incentivize private sector investment. Dutch Harbor on the Aleutian Chain offers vessel repair services; however, questions arise if the market can support another base closer to the sea route for vessel repairs or if the disabled vessel should be towed to Dutch Harbor.

Additional challenges unique to the Arctic include the generally unproven effectiveness of environmental cleanup measures in the region and the unknown impacts of shipping, let alone a spill, on the subsistence culture of the Arctic residents who depend on the ecosystem for their existence.

For an effective management system, international coordination is also needed between the US, Russia, Canada, and other participating countries to jointly develop standards for the Northern Sea Route.

An Arctic port provides one facet of supporting a safe seaway. Developing an Arctic port could provide a base of operations for search and rescue operations, tug services, vessel communication systems, and vessel repair services. The US currently lacks any deep water port in the region with Dutch Harbor being the closest port with a suitable level of vessel support.

Alaska Senator Mark Begich recognizes the importance

of the managed development of Alaska's Arctic. He recently stated: "Alaskans have always looked north to the future and today that means the rapidly changing Arctic. Unlocking this region's energy, shipping channels, tourism opportunities, and one day its fisheries, will be major contributors to the future economy of Alaska and the broader Pacific Northwest region. Our challenge today is to address the region's critical infrastructure needs - including a deep water port. I am committed to port development to facilitate and prepare for future activity in the Arctic and appreciate the support and work of PNWER to help make an Arctic port a reality."

HDR has a long successful history of addressing multilayered issues systematically by bringing together key experts to address complex issues. HDR's cadre of international experts is solutions-based and works well with clients, industry and the affected public to come up with workable answers to the most intricate issues.

Solutions for the Newest Frontier's issues must produce viable results in the near term as well as provide the foundation for effective long term management of the Arctic's resources. HDR looks forward to teaming with government, industries and communities to be part of the solution to the complexities facing Alaska as the Arctic supports increasing vessel shipping activity.

This article is a submission by, and reflects the views of, 2013 Annual Summit Sponsor HDR. The Pacific NorthWest Economic Region is not responsible for the content of this piece.



Dean Allen, CEO, McKinstry addresses legislators participating in PNWER's Legislative Energy Horizon Institute (LEHI), which educates policy-makers about energy policy. LEHI is one of several PNWER initiatives and has been educating legislators since 2009

PNWER gratefully thanks our premier sponsors for supporting the 2013 Annual Summit

2013 Premier Sponsors

Presenting Sponsor



Premier Sponsors



COUNCIL FOR
BIOTECHNOLOGY
INFORMATION
Good ideas are growing



2013 Supporting Sponsors

PNWER gratefully thanks our additional sponsors for supporting the 2013 Annual Summit

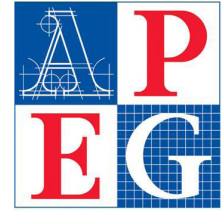

Professional Engineers
and Geoscientists of BC
www.apeg.bc.ca



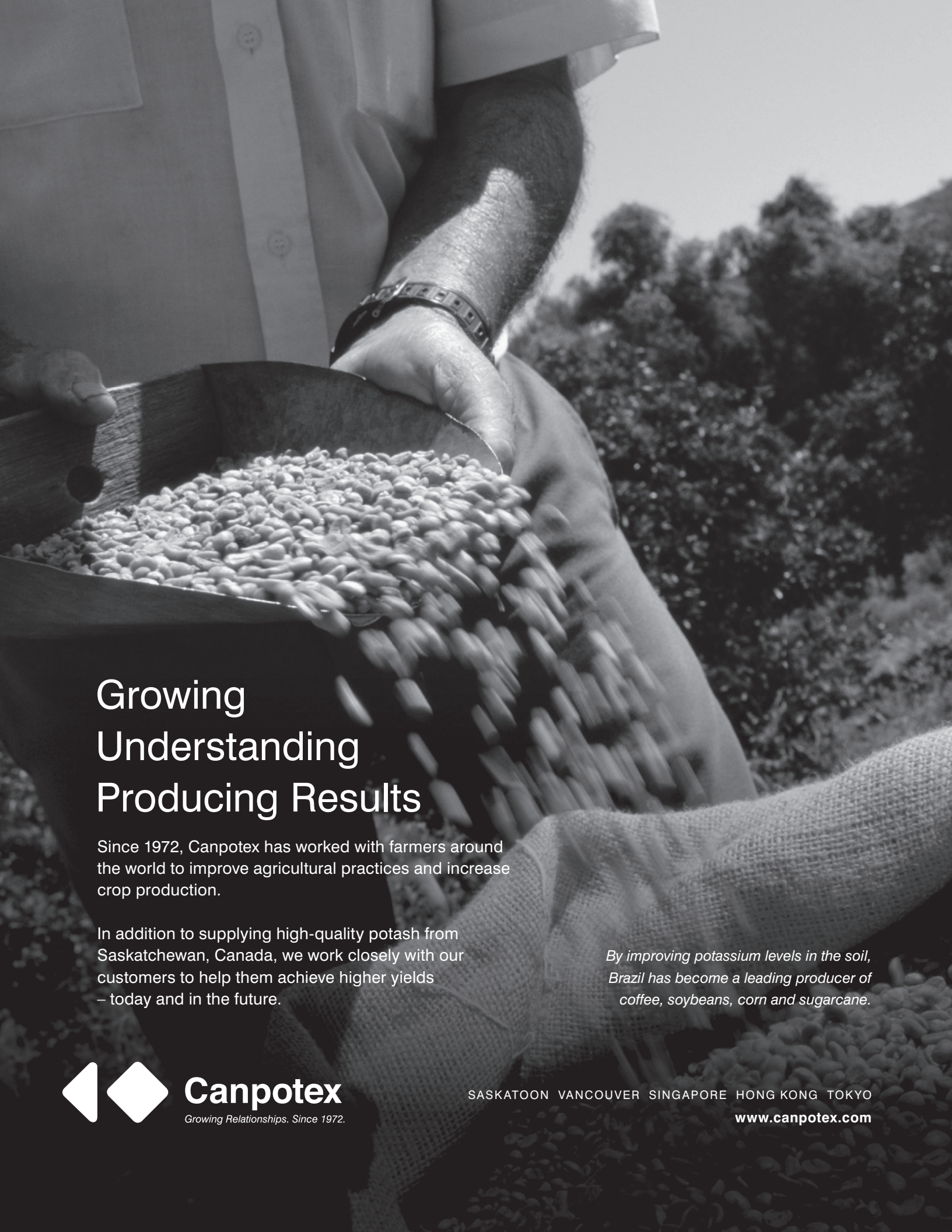

Growing Understanding Producing Results

Since 1972, Canpotex has worked with farmers around the world to improve agricultural practices and increase crop production.

In addition to supplying high-quality potash from Saskatchewan, Canada, we work closely with our customers to help them achieve higher yields – today and in the future.

By improving potassium levels in the soil, Brazil has become a leading producer of coffee, soybeans, corn and sugarcane.



Canpotex
Growing Relationships. Since 1972.

SASKATOON VANCOUVER SINGAPORE HONG KONG TOKYO

www.canpotex.com



BP is proud to support the Pacific NorthWest Economic Region's 23rd Annual Summit.



© 2011 BP Products North America Inc.



**Proudly brought to you
by Professionals in
Geoscience and Engineering**



WE MAKE A DIFFERENCE

www.apega.ca

Making Business Work for a Half Century



Representing almost 18,000 technicians and technologists across Alberta, ASET has been providing its members the professional certification that top employers demand since 1963. ASET members have been playing an integral role in driving the Alberta economy and their innovation is one reason why the province maintains its competitive advantage.

ASET members represent a wide range of sectors including avionics, biomedical, chemical, computers, electrical, environmental, geological, instrumentation, oil and gas, and telecommunications.



*The Association of Science
and Engineering Technology
Professionals of Alberta*

For more information about ASET, membership, and benefits, please call 1.800.272.5619, or visit our website at aset.ab.ca

ENERGY AT WORK FOR ALL CANADIANS

Canada is the third-largest producer of natural gas in the world and home to the world's third-largest reserves of oil. Leading experts agree, oil and natural gas will be a foundational part of the world's energy mix for decades to come. Canada's oil and natural gas industry is dedicated to environmentally and socially responsible development, returning energy and economic benefits to all Canadians. Find out more at capp.ca



Alaska's Oil & Gas Company Welcomes PNWER's 23rd Summit to Anchorage

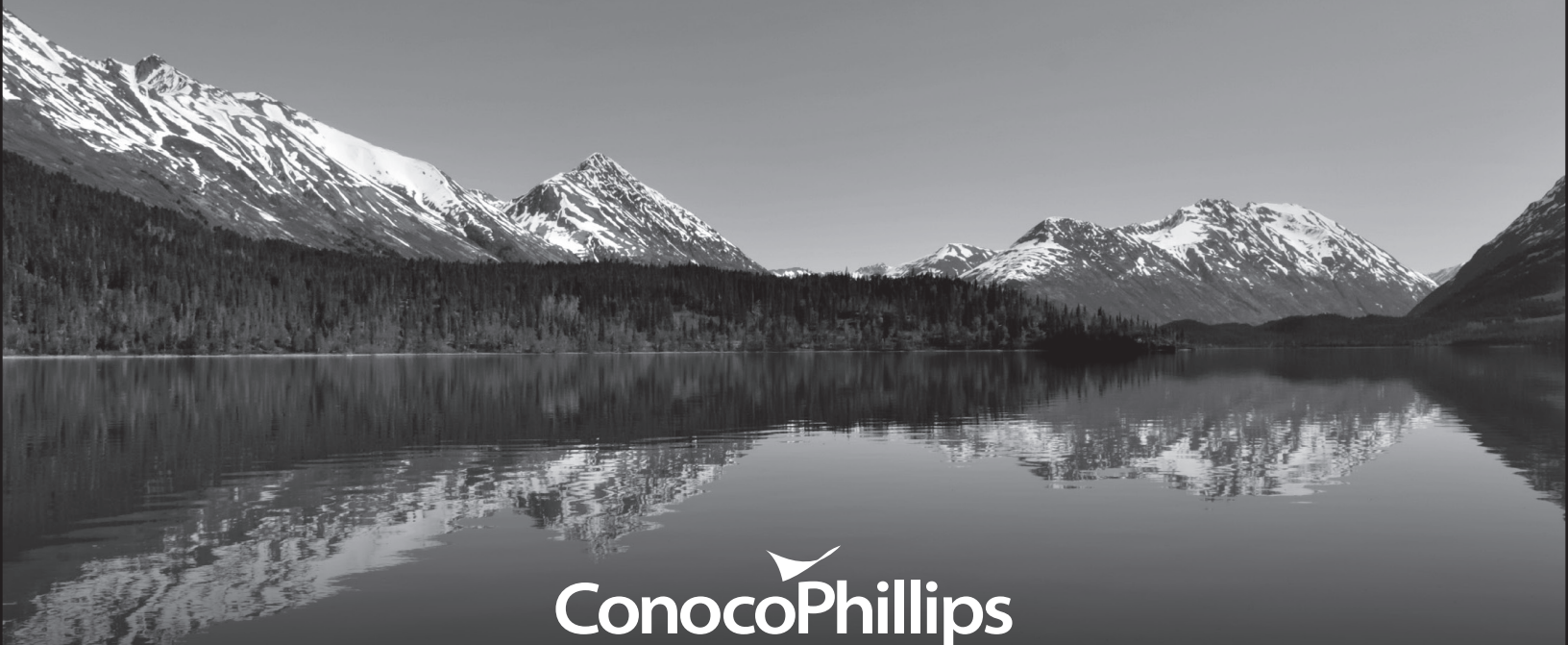

ConocoPhillips

WHERE ENERGY MEETS OUR FUTURE

Enbridge is a leader in the safe and reliable energy delivery in North America.

Enbridge is proud to operate the world's longest, most sophisticated crude oil and liquids transportation system. We also have a growing presence in the natural gas transmission and midstream business as well as power transmission. In addition, we're expanding our interests in renewable and green technologies including wind, solar and geothermal.

Enbridge delivers more than the energy you count on. We deliver on our promise to help make communities better places to live. It's part of the reason we were named one of the Global 100 Most Sustainable Corporations in the World.

FIND OUT MORE

EnbridgeUS.com



Crops enhanced through modern plant breeding help farmers harvest higher yields without increasing the amount of land they farm. This means valuable green spaces and wildlife are protected.

www.whybiotech.ca



COUNCIL FOR
BIOTECHNOLOGY
INFORMATION
Good ideas are **growing**

At TransCanada, we don't
just build pipelines.
We build relationships.



Proud supporter of the PNWER Summit



Canadians enjoy one of the safest,
most abundant food supplies in the
world. Modern agricultural solutions
play a big role in making that possible.

Farmers grow better crops thanks to pesticides
and modern plant breeding. This benefits us all.
For example, enhanced crops and pesticides help
save the average Canadian family close to 60%
on their weekly grocery bills.

www.croplife.ca



www.transcanada.com



The Northwest Gas Association's
mission is to advance the safe,
dependable and responsible use
of natural gas as integral to the
environmental, energy and
economic
future
of the PNW. Its
efforts foster greater
understanding and
informed decision-
making among
industry participants,
opinion leaders and
governing officials in the Pacific
Northwest on issues related to natural gas.



t: 503.344.6637
www.nwga.org



Fresh thinking and inspired outlooks start here.

At Cenovus, we support programs and events that help passionate people come up with new ideas and new approaches for the development of energy resources. Cenovus Energy. A Canadian oil company.

cenovus.com



cenovus
ENERGY

New ideas. New approaches.



Canadian Natural

www.cnrl.com

Canadian Natural Resources Limited has a long-term commitment to the communities in which we operate. We strive to contribute to their quality of life by creating opportunities for economic participation, locally and regionally.

Working cooperatively and effectively with stakeholders leads to a better, more sustainable energy industry.

Canadian Natural wishes all PNWER delegates a successful event

devon

Commitment Runs Deep

“Devon stresses safety, environment and then production... in that order.,”

- Devon employee

Learn more about Devon's values at www.devonenergy.com

FORTUNE 100 Best Companies to Work For® 2013



Committed to responsibly developing Alaska's natural resources



ExxonMobil

Taking on the world's toughest energy challenges.™

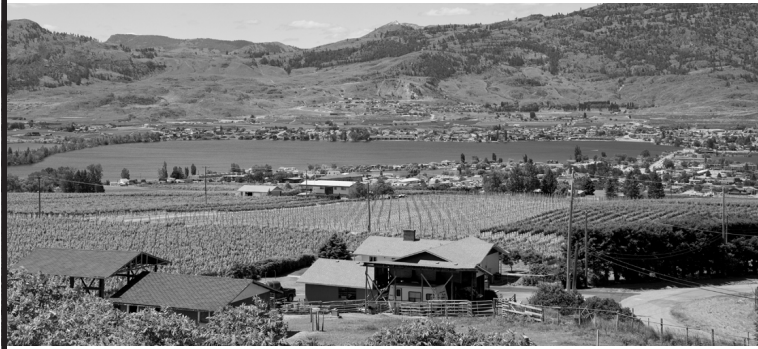

Energy solutions for every customer

FortisBC works hard to ensure the energy our customers rely on is there whenever they need it. From electricity and natural gas, including natural gas for transportation, to propane and thermal energy, we provide solutions for your community. Learn more at fortisbc.com.

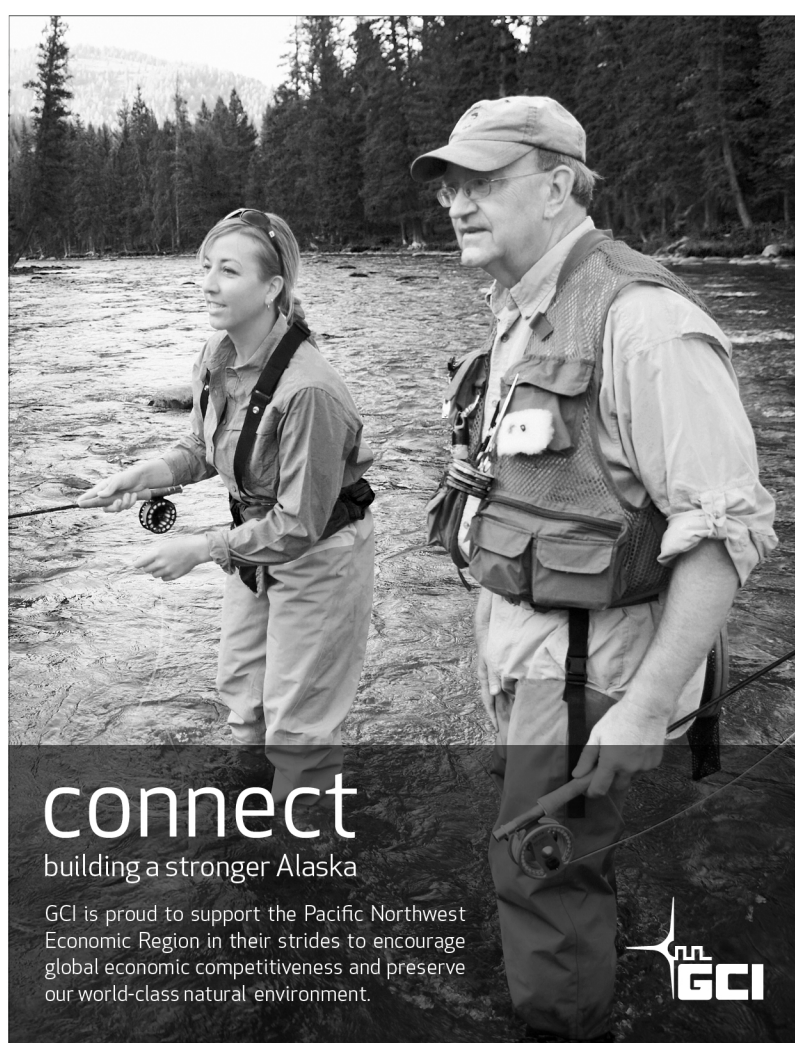

connect building a stronger Alaska

GCI is proud to support the Pacific Northwest Economic Region in their strides to encourage global economic competitiveness and preserve our world-class natural environment.



Nelson Mullins[®] Nelson Mullins Riley & Scarborough LLP

and

Ambassador David Wilkins

Are proud to sponsor the

PNWER 23rd Annual Summit



Nelson Mullins Riley & Scarborough LLP
Poinsett Plaza | Suite 900
104 South Main Street
Greenville, SC 29601
www.nelsonmullins.com | 864.250.2300
David H. Wilkins, Partner





Mark your calendars!

July 20 -24, 2014
Whistler, British Columbia



Pacific North West Economic Region
24TH ANNUAL SUMMIT



Hotel Captain Cook Lobby Level

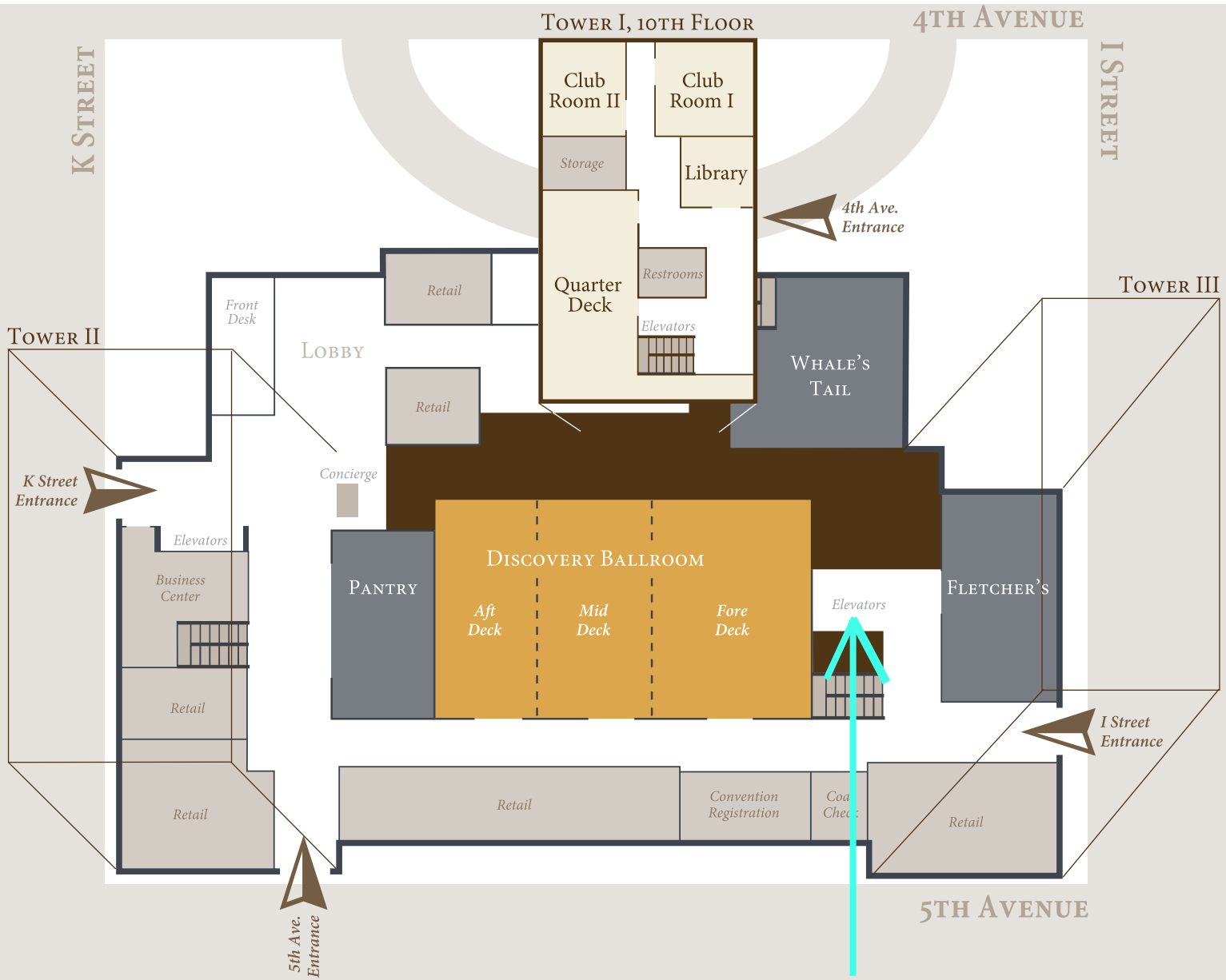

Please use these elevators to access the 19th floor, Crows Nest Suite for the Sunday Evening Hospitality Suite.

Dena'ina Conference Center Second Floor

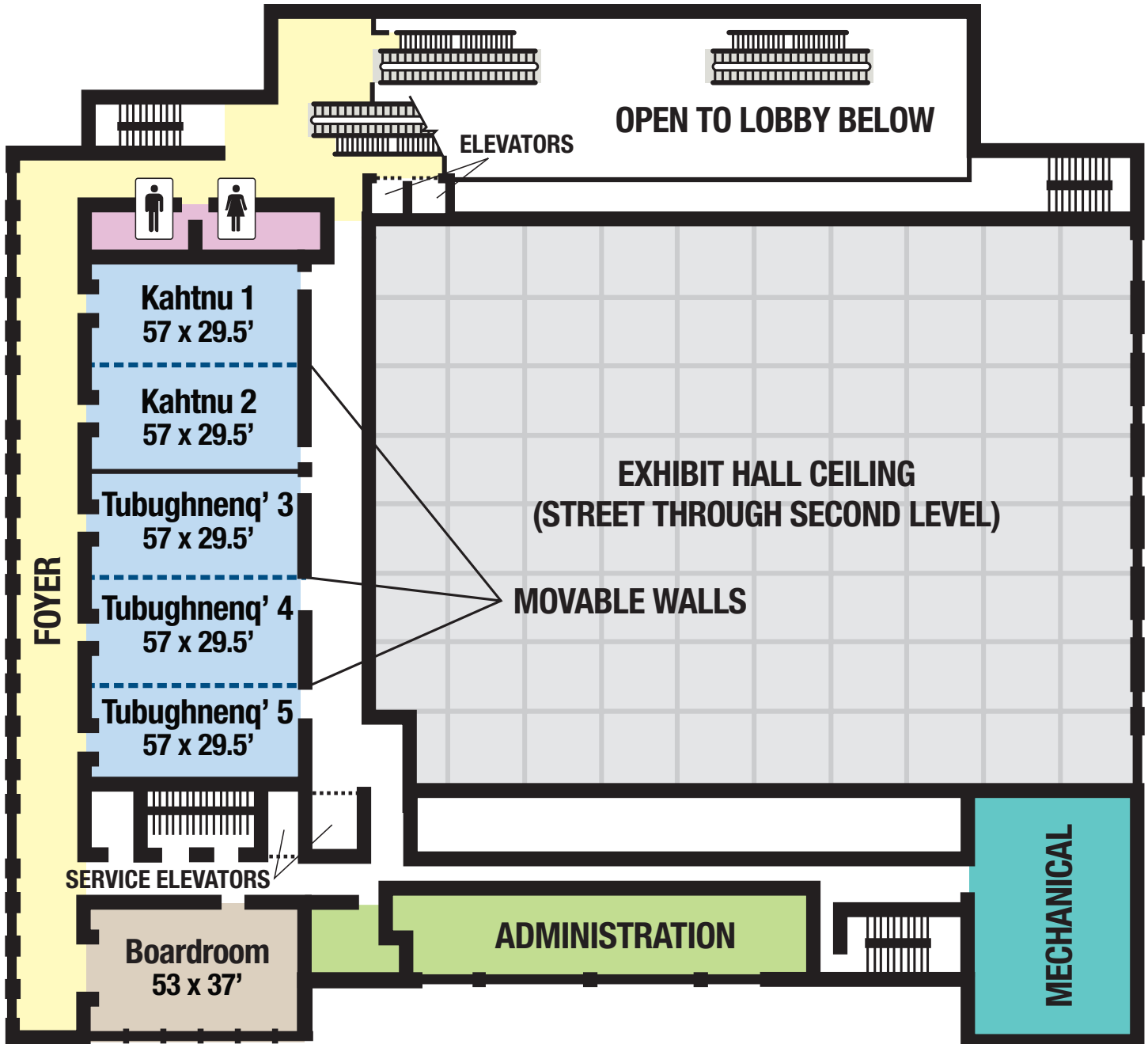

Dena'ina Conference Center Third Floor

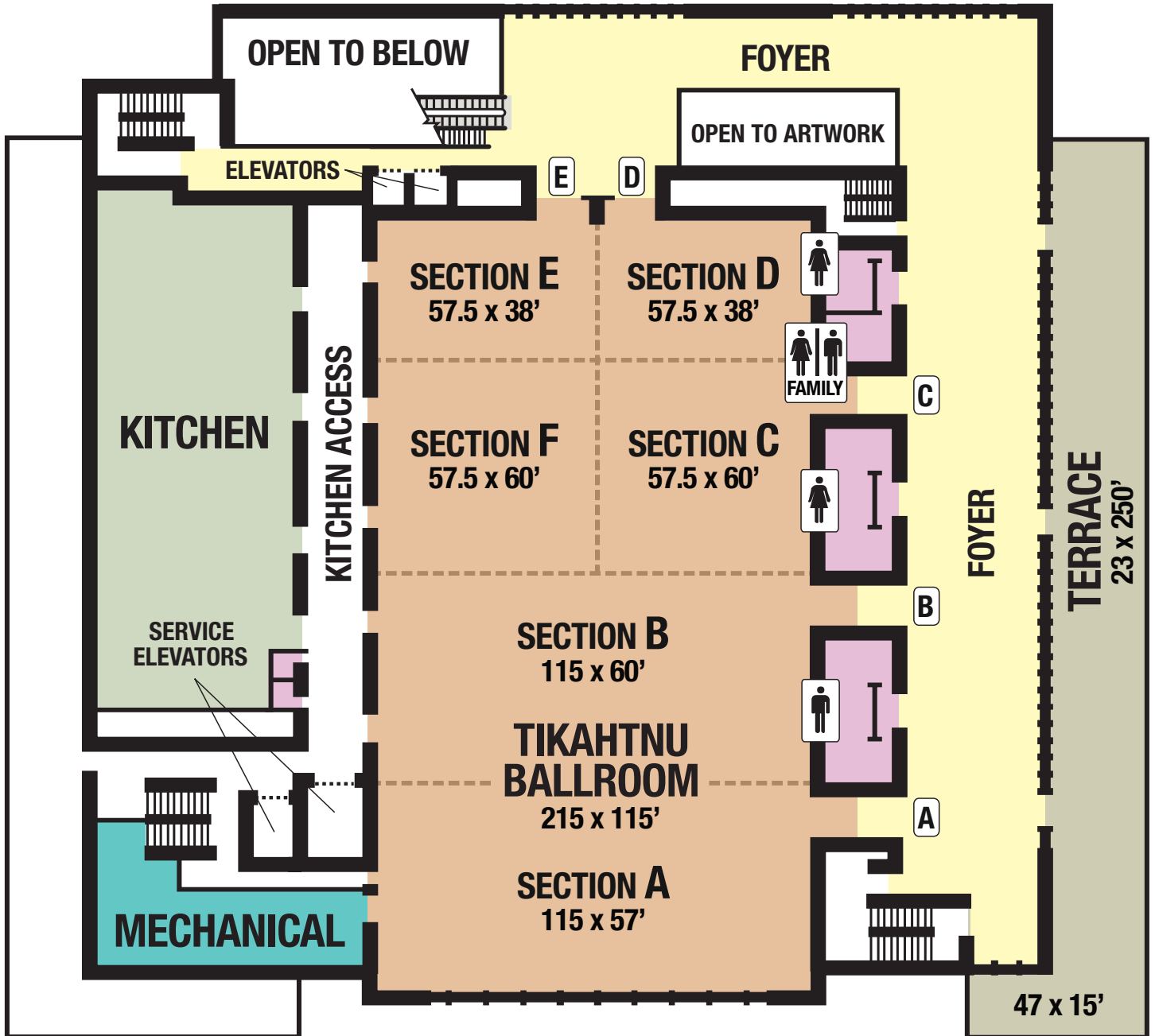

Marriott Downtown Anchorage Second Floor

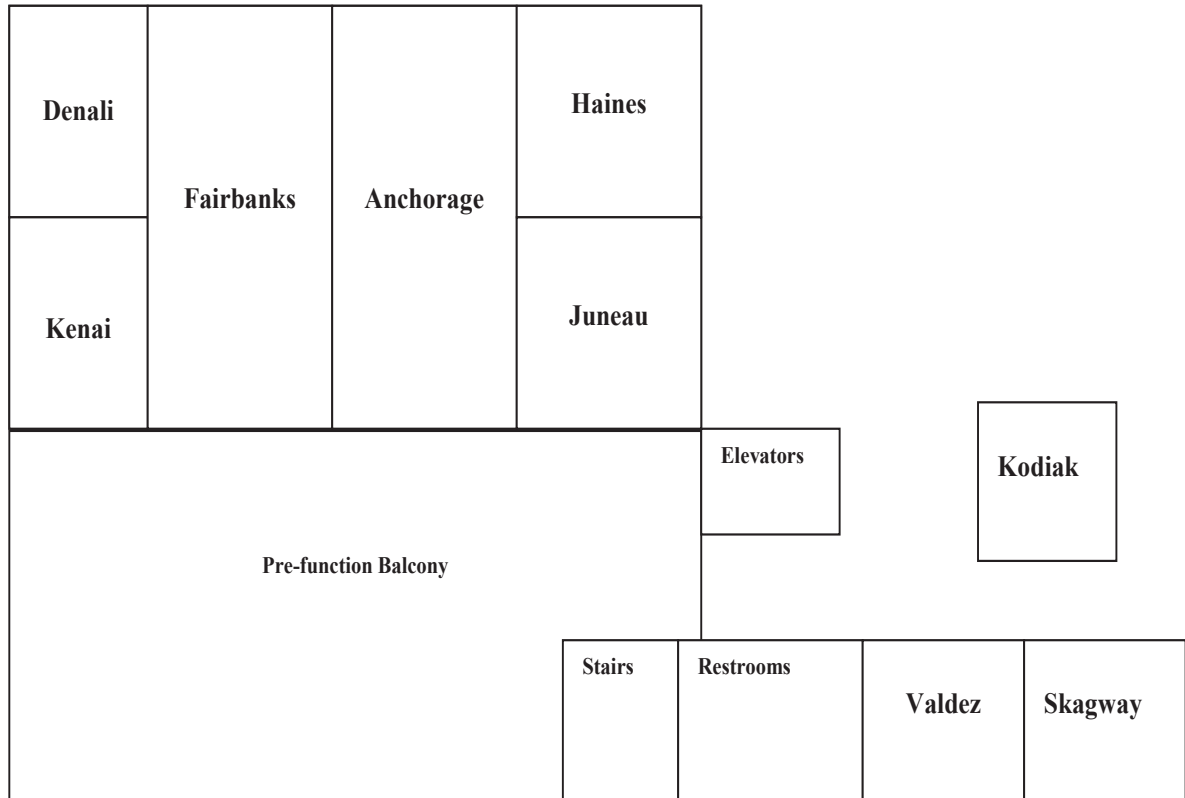

City of Anchorage Street Map

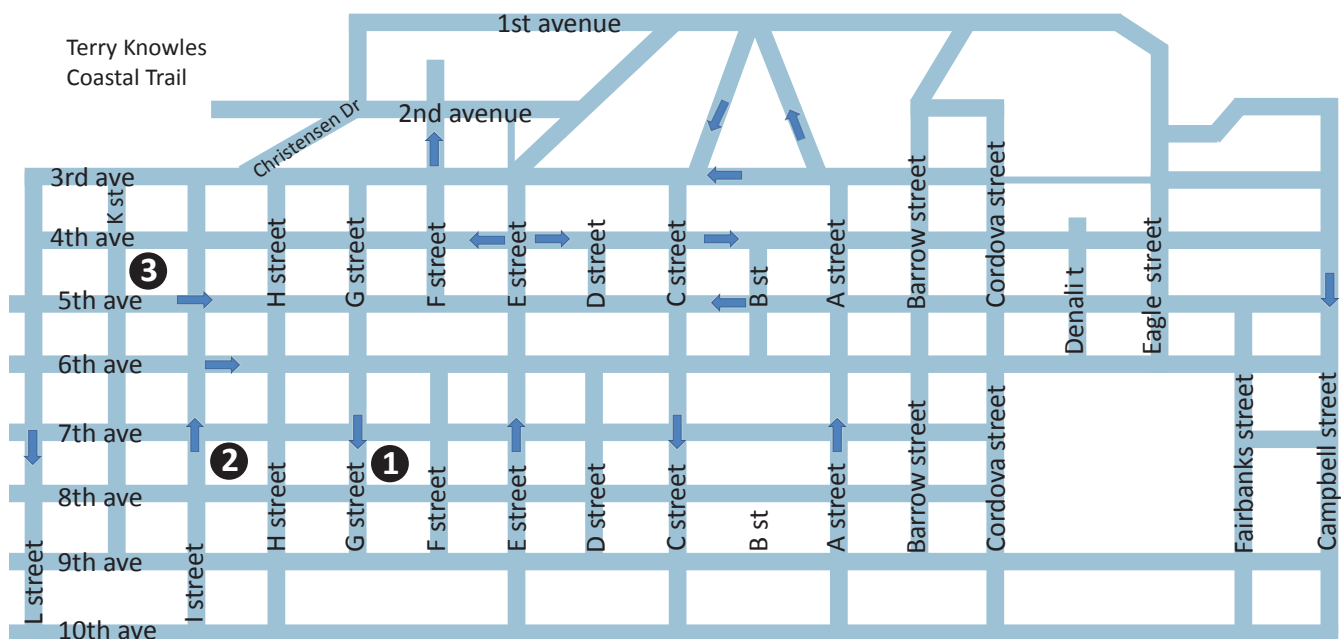

- ❶ Dena'ina Conference and Convention Center | 600 West 7th Avenue
- ❷ Marriott Downtown Anchorage | 820 West 7th Ave
- ❸ The Hotel Captain Cook | 939 West 5th Avenue